

## CR 99212 CR

Wear sleeves

TYPE: Wear sleeves, SKF Speedi-Sleeve, Speedi-Sleeve (SKF)

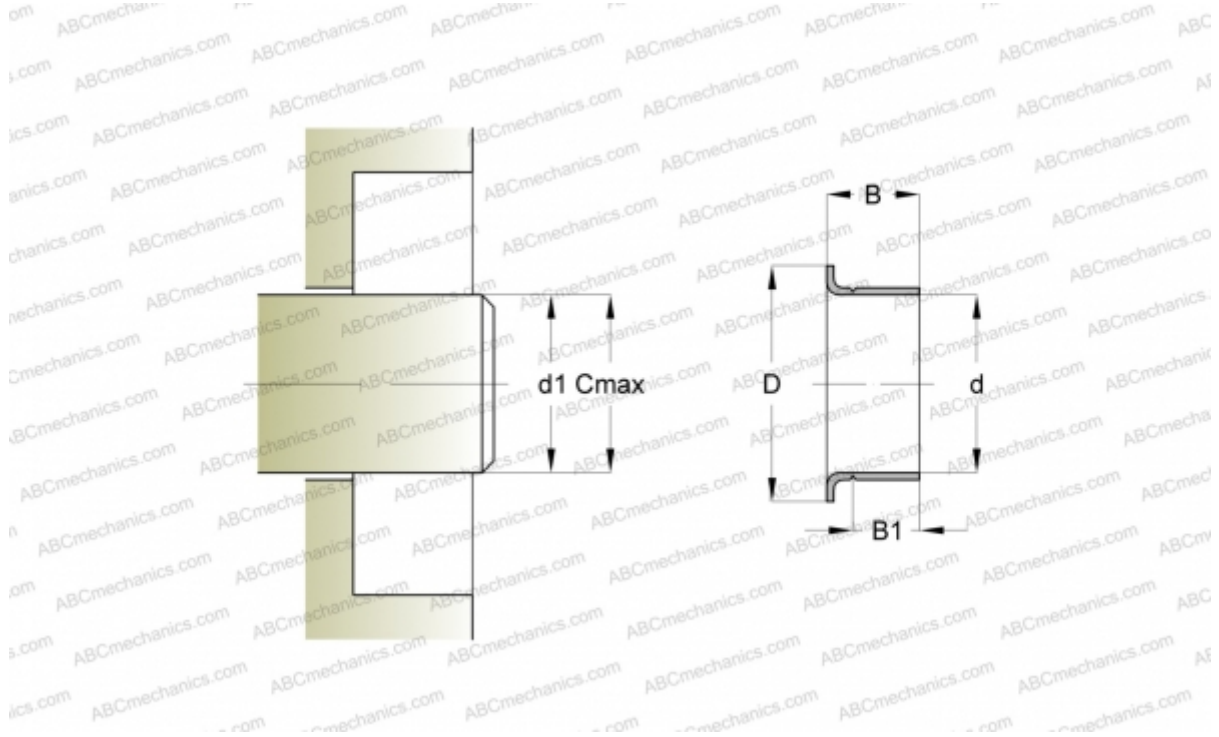

### Technical specification

#### DIMENSIONS, MM

d1	53,950
d	53,980
D	61,520
B	23,830
B1	19,840
C	54,100

**MANUFACTURER** [CR](#)

#### INTERCHANGE

SKF [99212](#)

#### CALCULATION DATA

Maximum shaft surface speed 0,001 m/s