

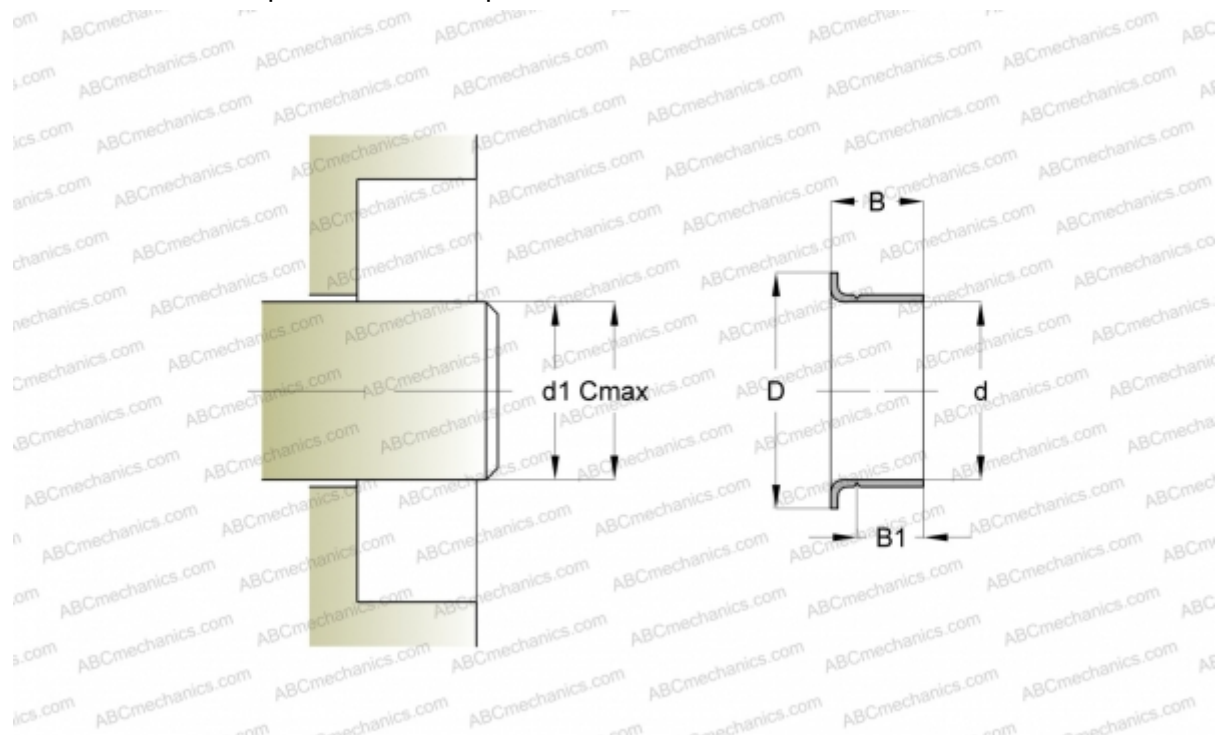

CR 99226 CR

Wear sleeves

TYPE: Wear sleeves, SKF Speedi-Sleeve, Speedi-Sleeve (SKF)



Technical specification

DIMENSIONS, MM

d1	56,820
d	56,900
D	65,100
B	22,860
B1	19,410
C	56,970

MANUFACTURER

[CR](#)

INTERCHANGE

SKF	99226
-----	-----------------------

CALCULATION DATA

Maximum shaft surface speed	0,001 m/s
-----------------------------	-----------

