

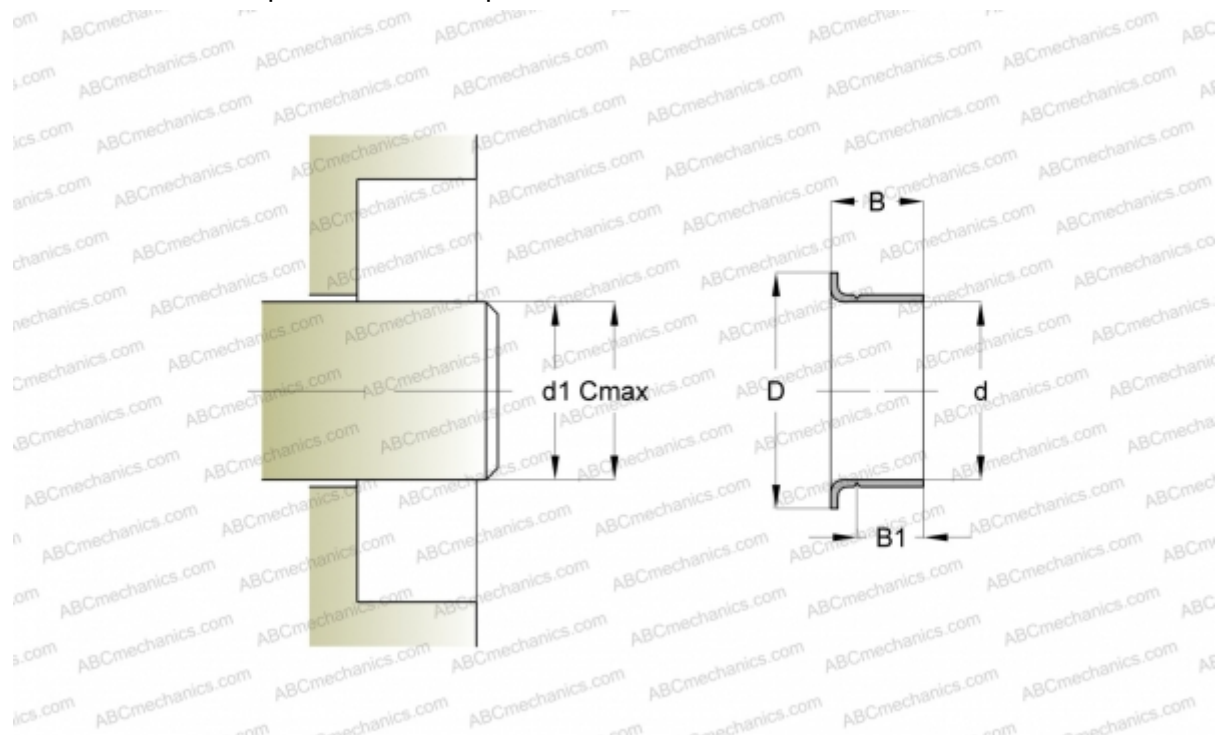

CR 99227 CR

Wear sleeves

TYPE: Wear sleeves, SKF Speedi-Sleeve, Speedi-Sleeve (SKF)



Technical specification

DIMENSIONS, MM

d1	57,120
d	57,150
D	64,290
B	11,130
B1	7,950
C	57,280

MANUFACTURER [CR](#)

INTERCHANGE

SKF	99227
-----	-----------------------

CALCULATION DATA

Maximum shaft surface speed	0,001 m/s
-----------------------------	-----------

