

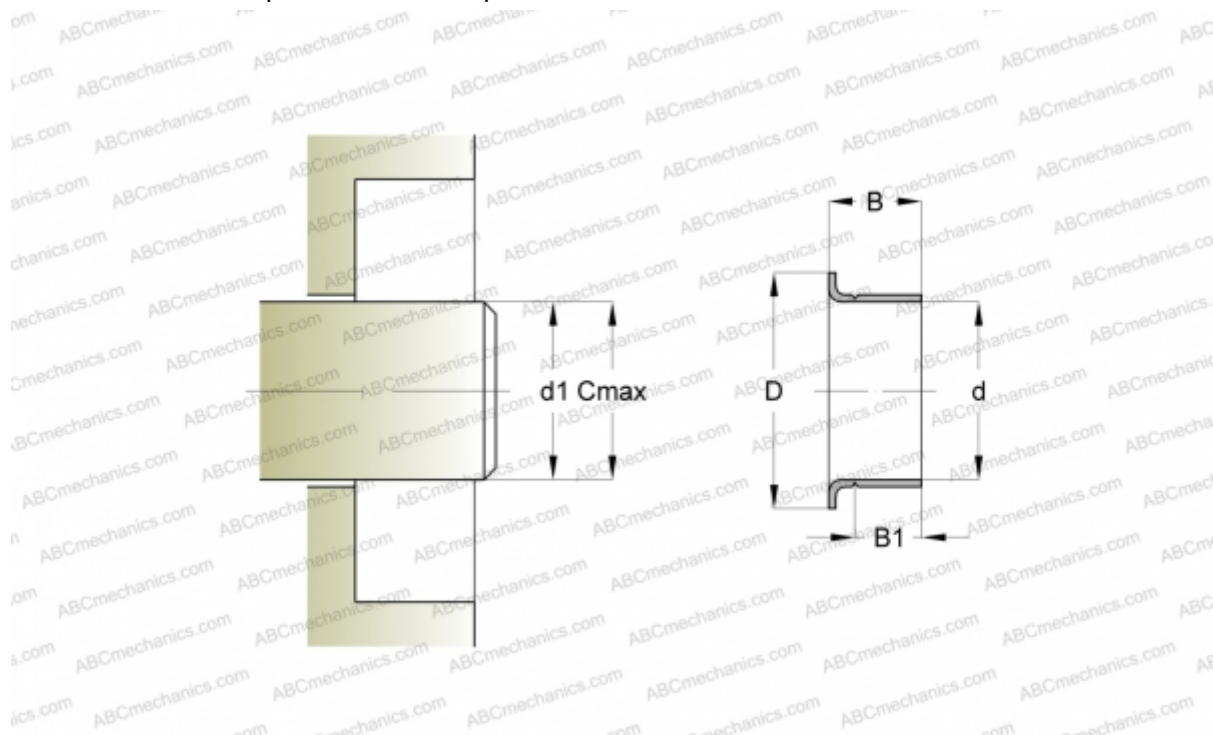

## 99225 SKF

Wear sleeves

TYPE: Wear sleeves, SKF Speedi-Sleeve, Speedi-Sleeve (SKF)



### Technical specification

#### DIMENSIONS, MM

d1	57,120
d	57,150
D	64,290
B	23,830
B1	19,840
C	57,280

#### MANUFACTURER

[SKF](#)

#### INTERCHANGE

CR	<a href="#">CR 99225</a>
----	--------------------------

#### CALCULATION DATA

Maximum shaft surface speed	0,001 m/s
-----------------------------	-----------

