

99235 SKF

Wear sleeves

TYPE: Wear sleeves, SKF Speedi-Sleeve, Speedi-Sleeve (SKF)

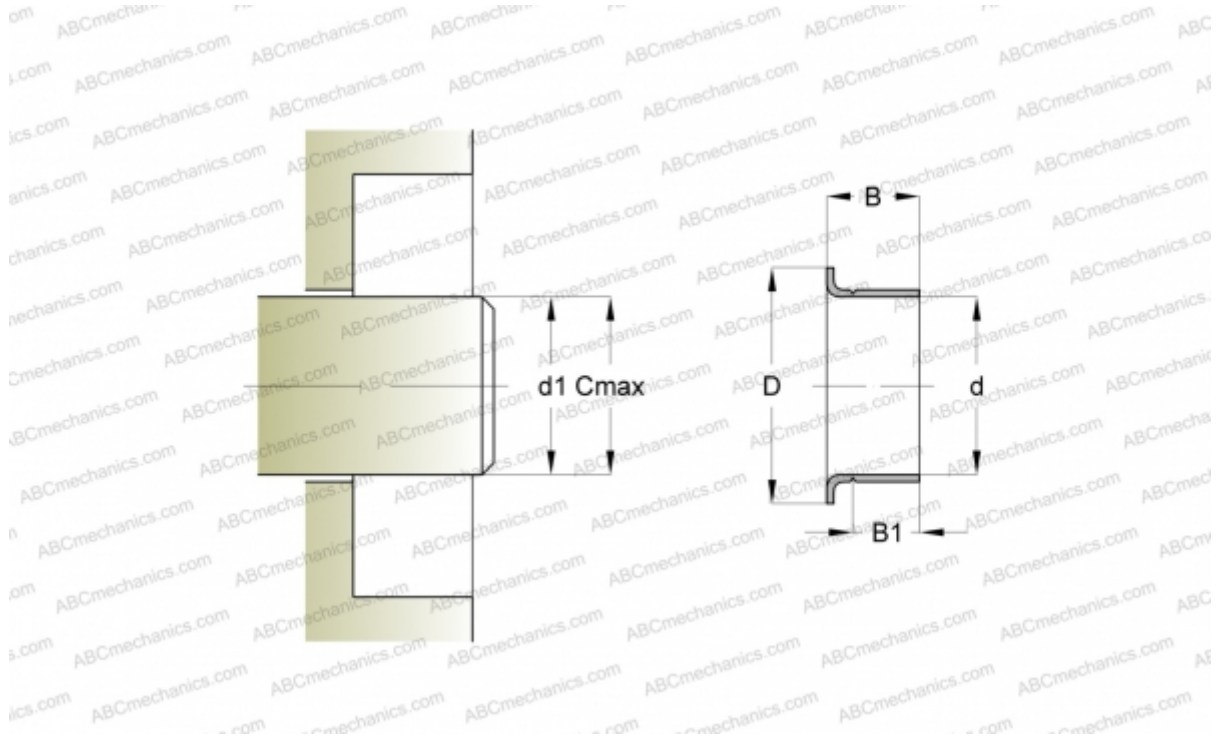

Technical specification

DIMENSIONS, MM

d1	59,920
d	59,990
D	70,740
B	22,990
B1	19,990
C	60,070

MANUFACTURER [SKF](#)

INTERCHANGE

CR [CR 99235](#)

CALCULATION DATA

Maximum shaft surface speed 0,001 m/s