

CR 99253 CR

Wear sleeves

TYPE: Wear sleeves, SKF Speedi-Sleeve, Speedi-Sleeve (SKF)

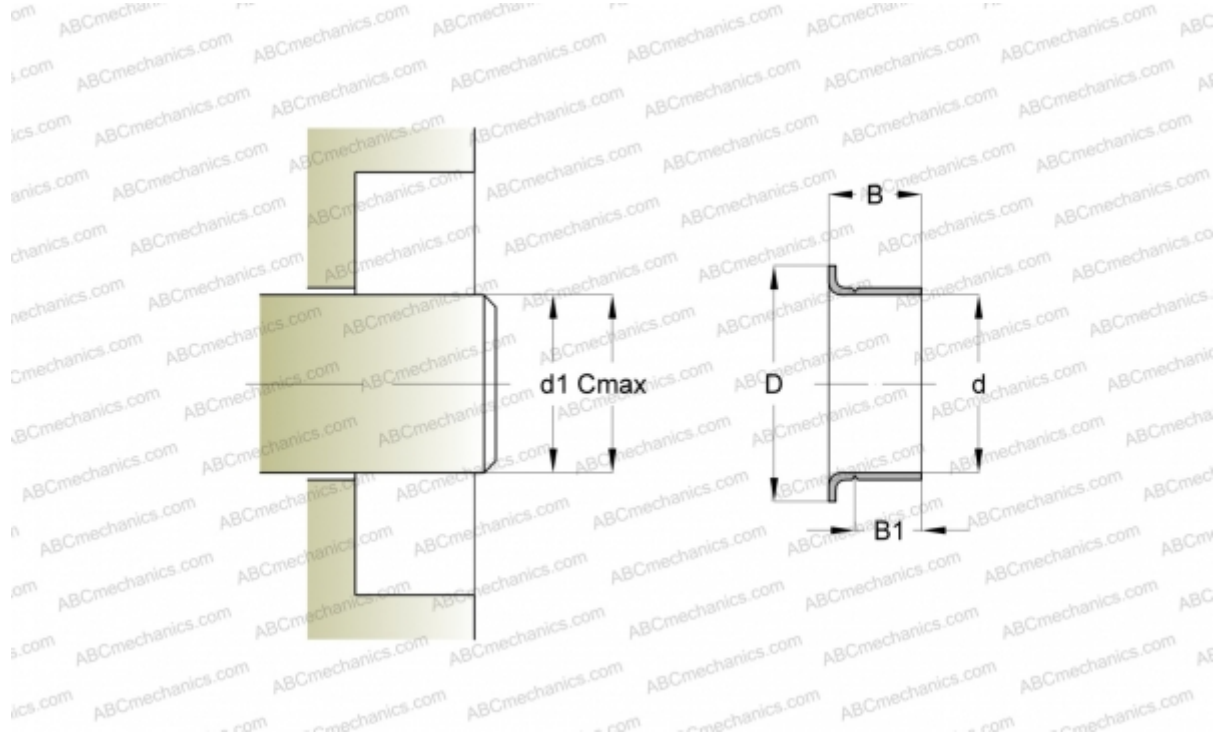

Technical specification

DIMENSIONS, MM

d1	63,420
d	63,500
D	71,630
B	16,510
B1	14,100
C	63,580

MANUFACTURER [CR](#)

INTERCHANGE

SKF [99253](#)

CALCULATION DATA

Maximum shaft surface speed 0,001 m/s