

99250 SKF

Wear sleeves

TYPE: Wear sleeves, SKF Speedi-Sleeve, Speedi-Sleeve (SKF)

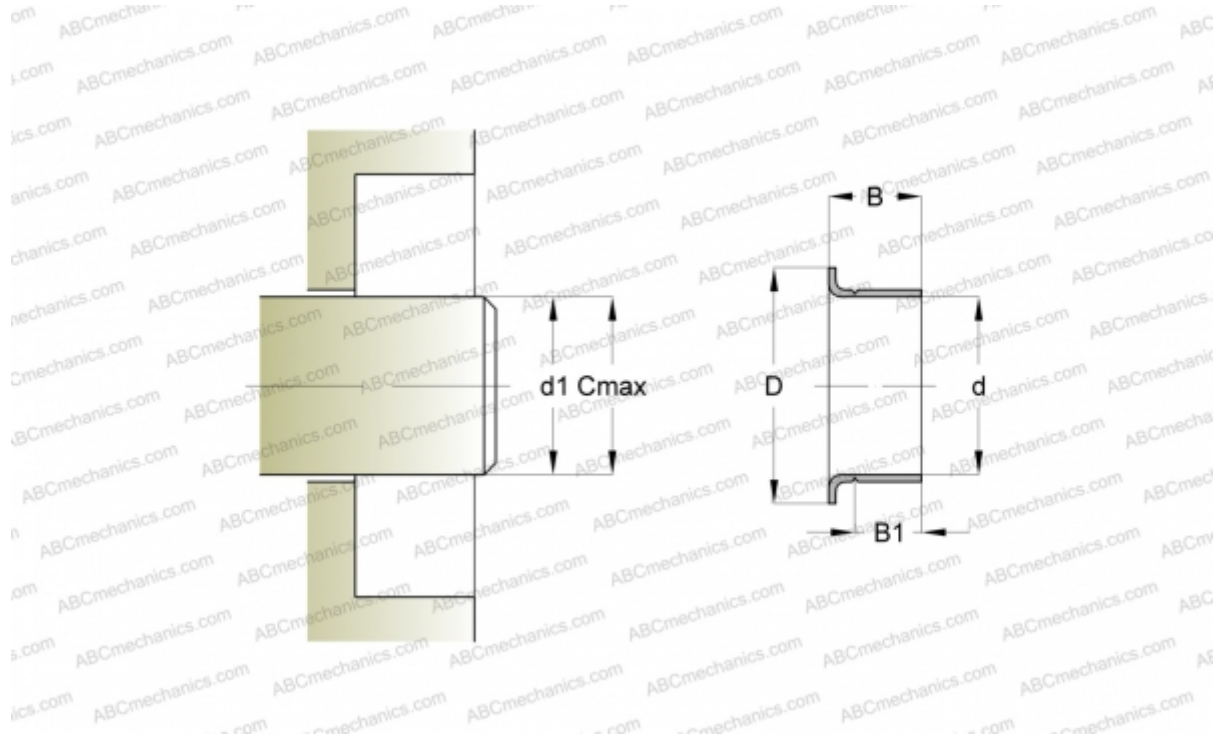

Technical specification

DIMENSIONS, MM

d1	63,500
d	63,500
D	71,630
B	23,830
B1	19,840
C	63,650

MANUFACTURER [SKF](#)

INTERCHANGE

CR [CR 99250](#)

CALCULATION DATA

Maximum shaft surface speed 0,001 m/s