

CR 99259 CR

Wear sleeves

TYPE: Wear sleeves, SKF Speedi-Sleeve, Speedi-Sleeve (SKF)

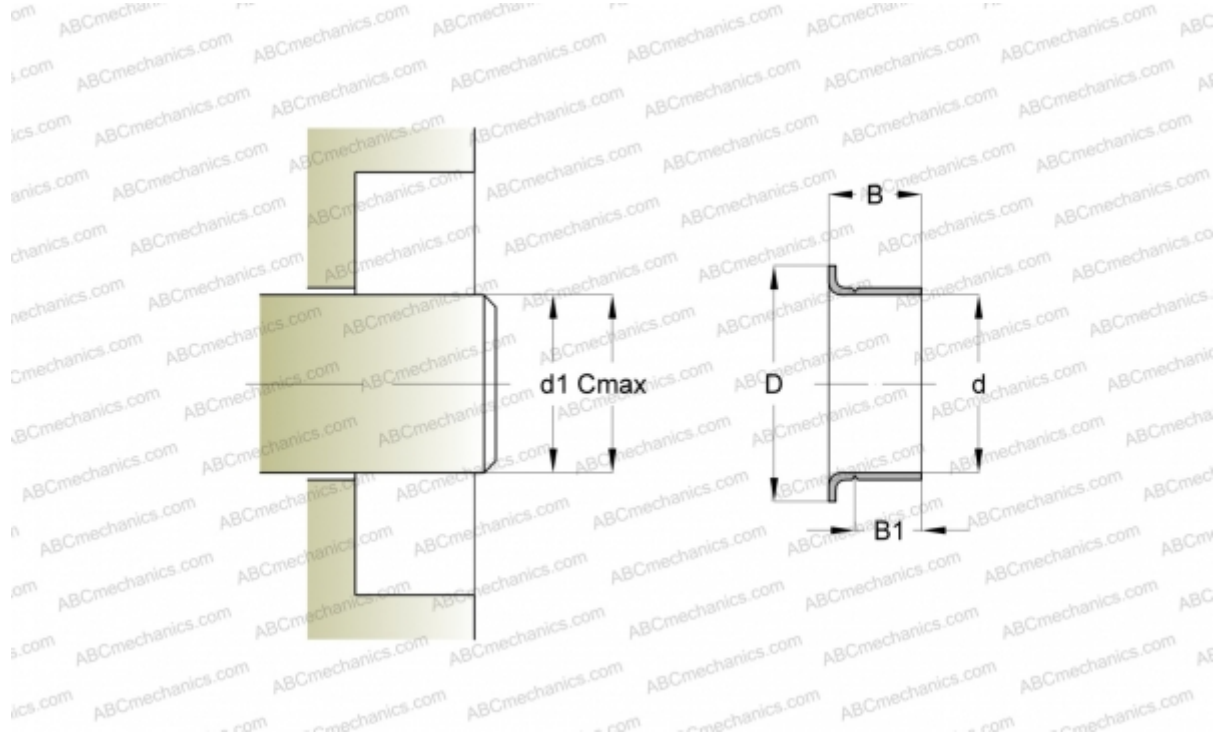

Technical specification

DIMENSIONS, MM

d1	65,910
d	65,990
D	75,950
B	23,830
B1	19,840
C	66,070

MANUFACTURER [CR](#)

INTERCHANGE

SKF [99259](#)

CALCULATION DATA

Maximum shaft surface speed 0,001 m/s