

CR 99261 CR

Wear sleeves

TYPE: Wear sleeves, SKF Speedi-Sleeve, Speedi-Sleeve (SKF)

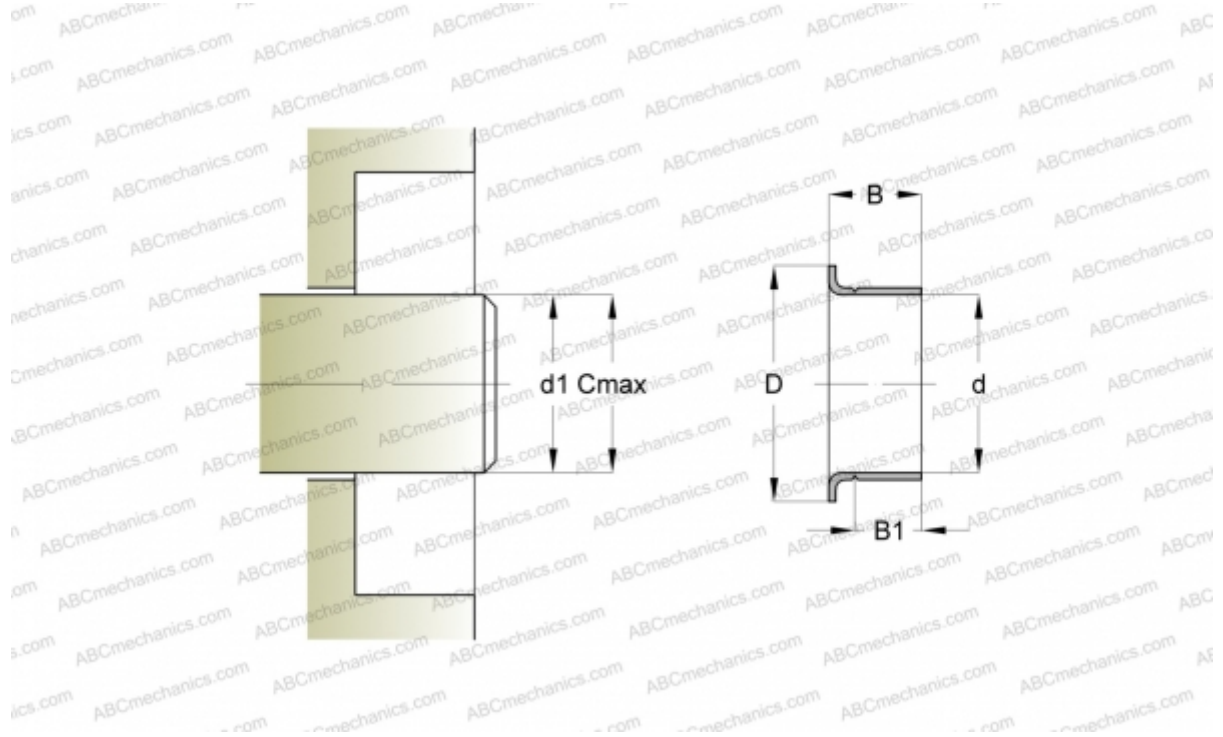

Technical specification

DIMENSIONS, MM

d1	66,500
d	66,570
D	77,390
B	23,830
B1	19,840
C	66,650

MANUFACTURER [CR](#)

INTERCHANGE

SKF [99261](#)

CALCULATION DATA

Maximum shaft surface speed 0,001 m/s