

99262 SKF

Wear sleeves

TYPE: Wear sleeves, SKF Speedi-Sleeve, Speedi-Sleeve (SKF)

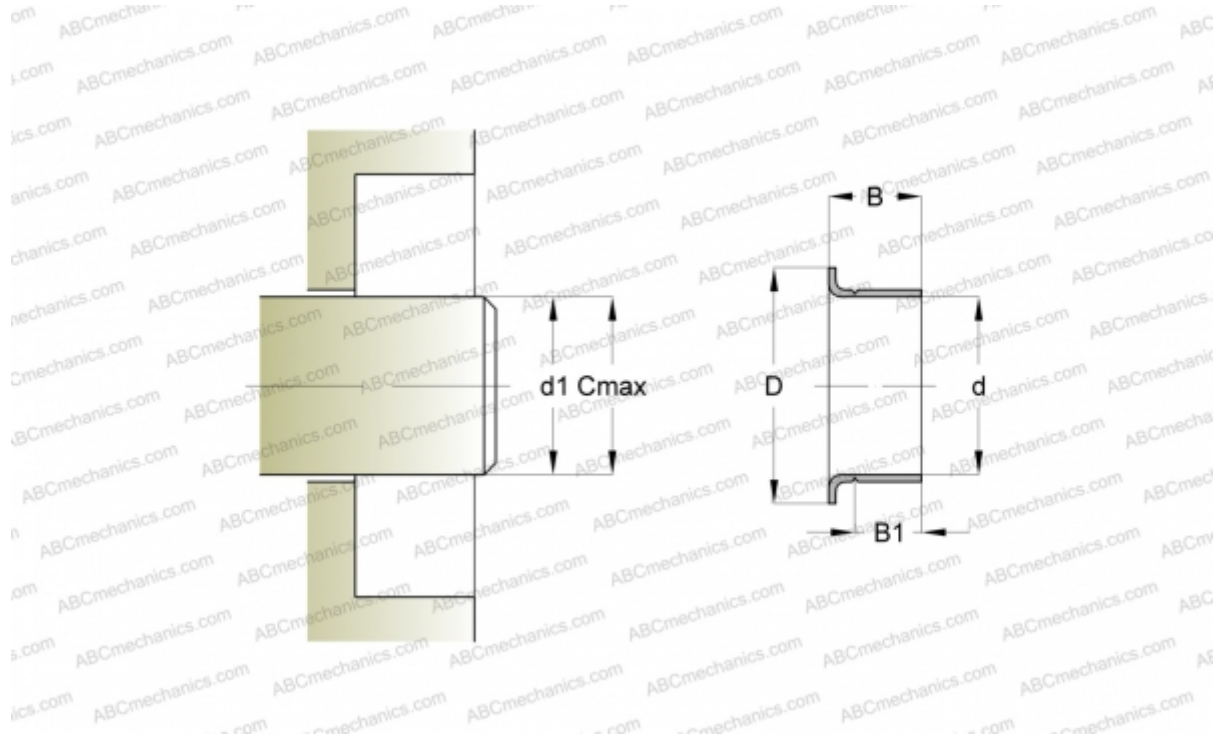

Technical specification

DIMENSIONS, MM

d1	66,680
d	66,680
D	77,390
B	23,830
B1	19,840
C	66,830

MANUFACTURER [SKF](#)

INTERCHANGE

CR [CR 99262](#)

CALCULATION DATA

Maximum shaft surface speed 0,001 m/s