

99266 SKF

Wear sleeves

TYPE: Wear sleeves, SKF Speedi-Sleeve, Speedi-Sleeve (SKF)

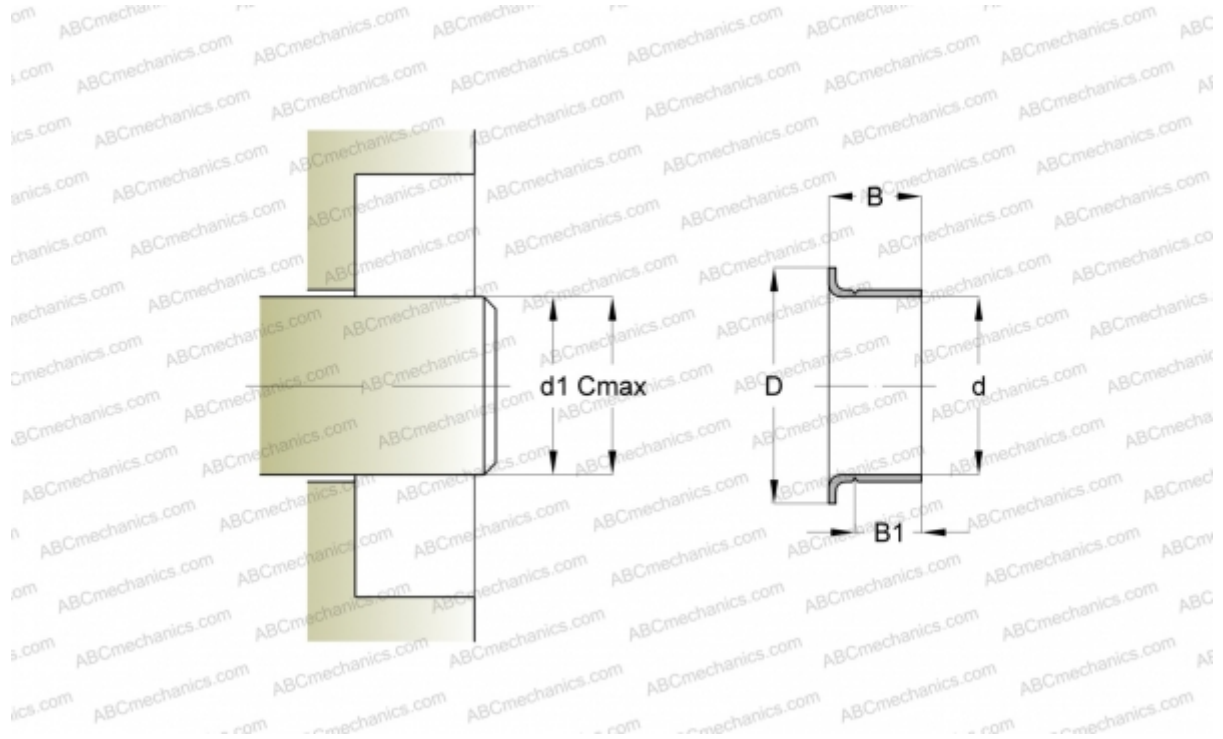

Technical specification

DIMENSIONS, MM

d1	67,820
d	68,000
D	79,380
B	22,230
B1	19,050
C	68,000

MANUFACTURER [SKF](#)

INTERCHANGE

CR [CR 99266](#)

CALCULATION DATA

Maximum shaft surface speed 0,001 m/s