

## 99273 SKF

Wear sleeves

TYPE: Wear sleeves, SKF Speedi-Sleeve, Speedi-Sleeve (SKF)

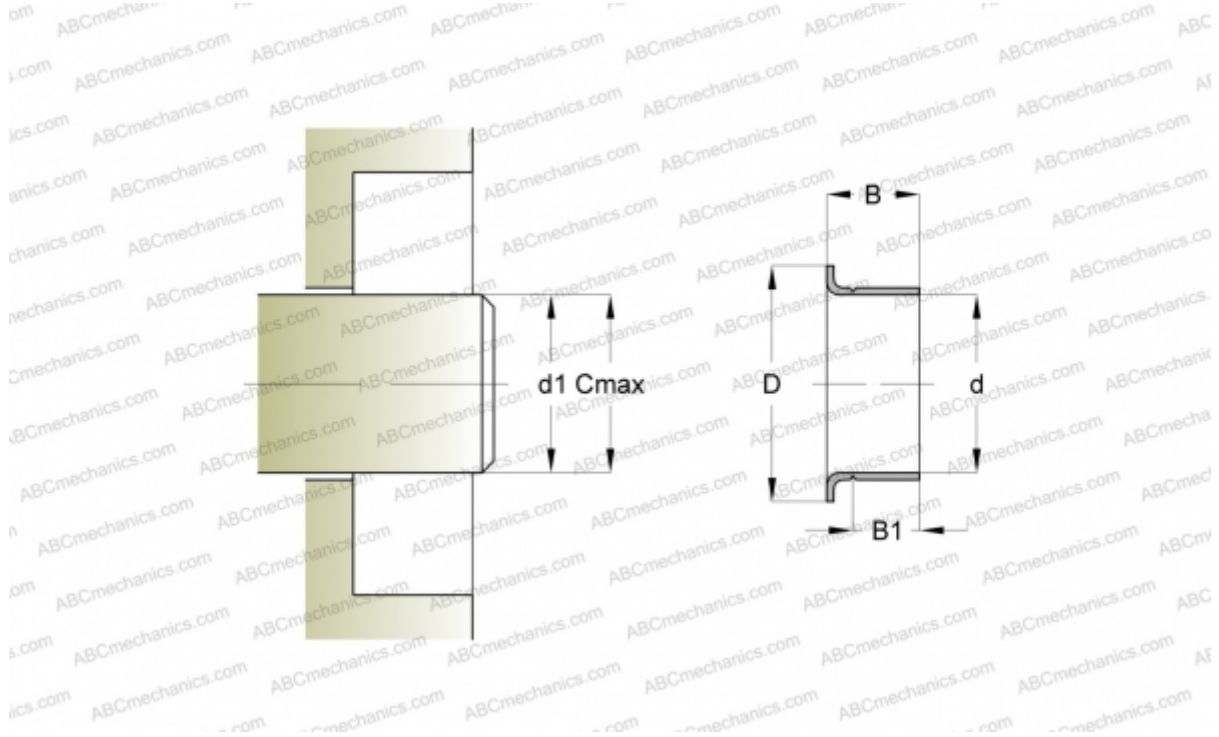

### Technical specification

#### DIMENSIONS, MM

d1	69,600
d	69,670
D	77,850
B	23,830
B1	19,840
C	69,750

**MANUFACTURER** [SKF](#)

#### INTERCHANGE

CR [CR 99273](#)

#### CALCULATION DATA

Maximum shaft surface speed 0,001 m/s