

99274 SKF

Wear sleeves

TYPE: Wear sleeves, SKF Speedi-Sleeve, Speedi-Sleeve (SKF)

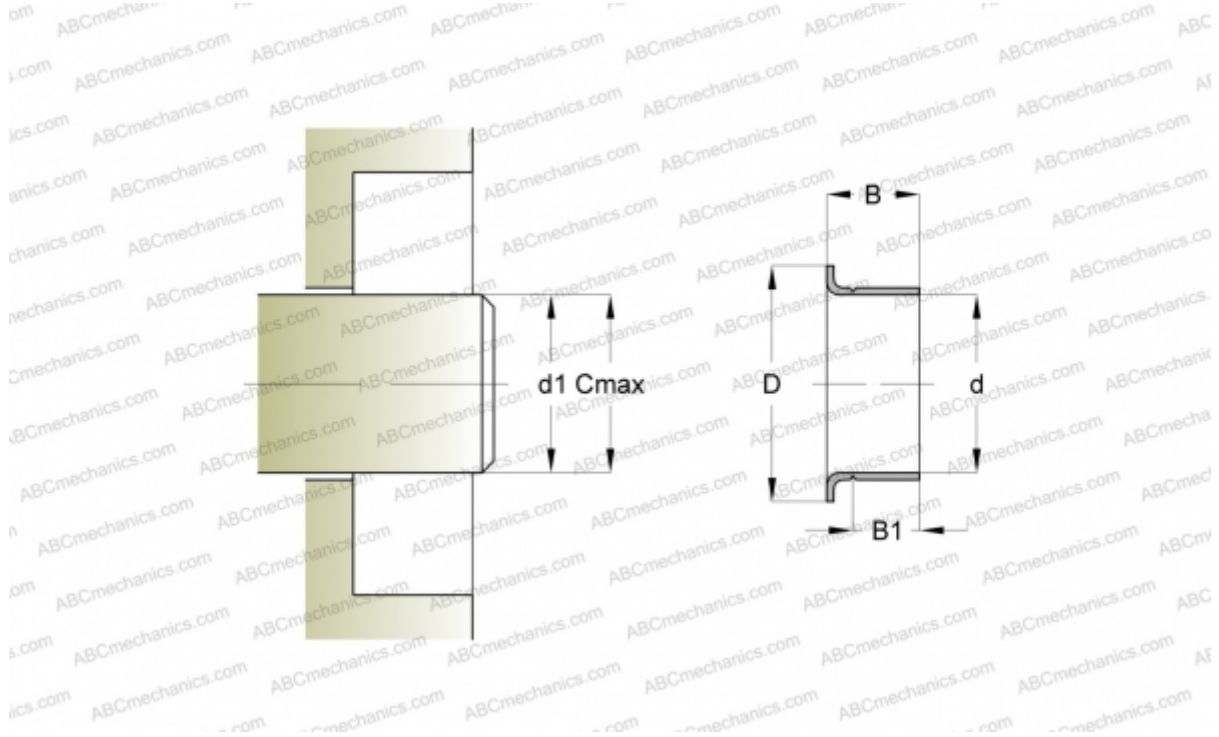

Technical specification

DIMENSIONS, MM

| | |
|----|--------|
| d1 | 69,720 |
| d | 69,850 |
| D | 79,380 |
| B | 23,830 |
| B1 | 19,840 |
| C | 69,880 |

MANUFACTURER [SKF](#)

INTERCHANGE

CR [CR 99274](#)

CALCULATION DATA

Maximum shaft surface speed 0,001 m/s