

## 99269 SKF

Wear sleeves

TYPE: Wear sleeves, SKF Speedi-Sleeve, Speedi-Sleeve (SKF)

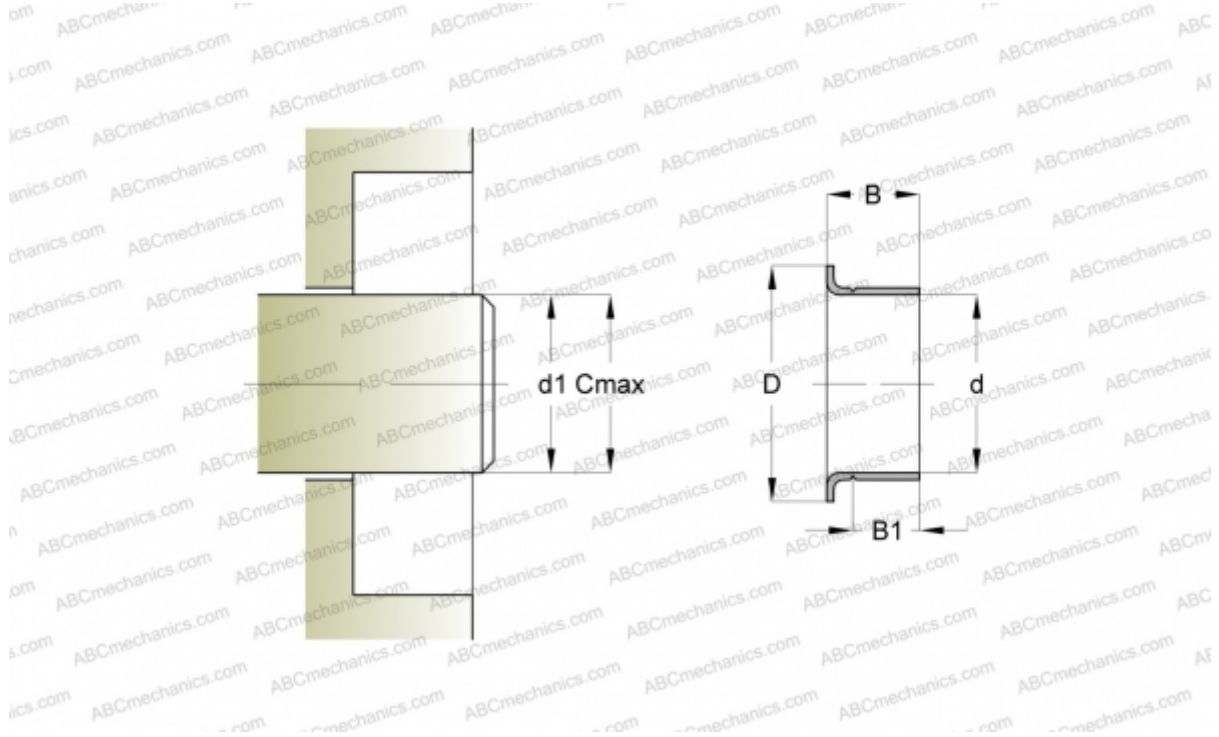

### Technical specification

#### DIMENSIONS, MM

d1	69,850
d	69,850
D	79,380
B	31,750
B1	28,580
C	70,000

**MANUFACTURER** [SKF](#)

#### INTERCHANGE

CR [CR 99269](#)

#### CALCULATION DATA

Maximum shaft surface speed 0,001 m/s