

## 99281 SKF

Wear sleeves

TYPE: Wear sleeves, SKF Speedi-Sleeve, Speedi-Sleeve (SKF)

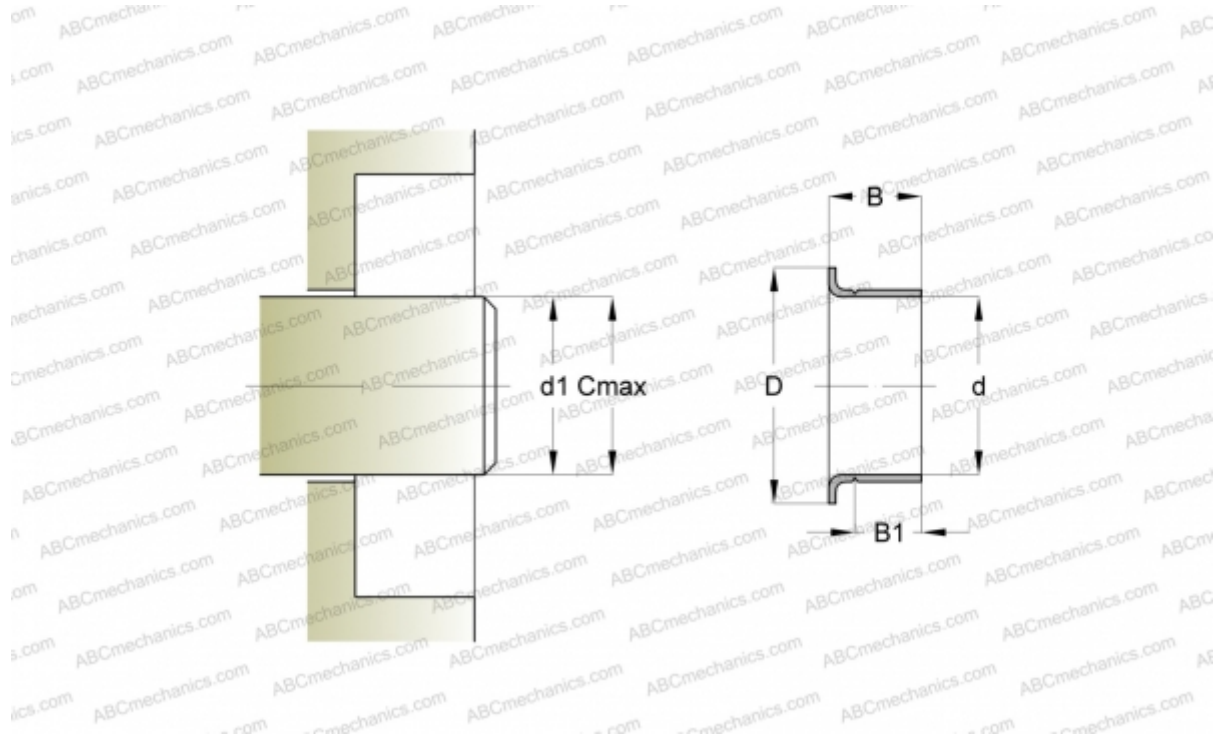

### Technical specification

#### DIMENSIONS, MM

d1	71,350
d	71,450
D	80,980
B	17,480
B1	15,090
C	71,500

**MANUFACTURER** [SKF](#)

#### INTERCHANGE

CR [CR 99281](#)

#### CALCULATION DATA

Maximum shaft surface speed 0,001 m/s