

CR 99282 CR

Wear sleeves

TYPE: Wear sleeves, SKF Speedi-Sleeve, Speedi-Sleeve (SKF)

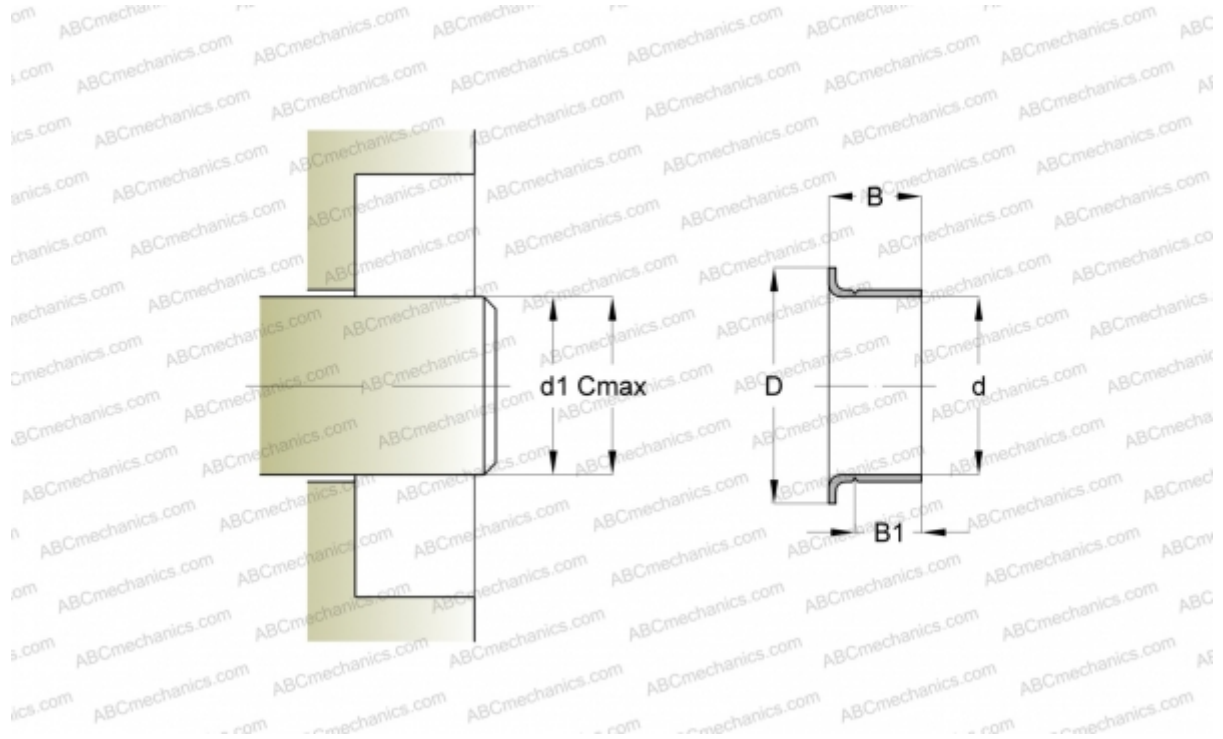

Technical specification

DIMENSIONS, MM

d1	72,090
d	72,090
D	81,920
B	16,660
B1	12,700
C	72,240

MANUFACTURER [CR](#)

INTERCHANGE

SKF [99282](#)

CALCULATION DATA

Maximum shaft surface speed 0,001 m/s