

99290 SKF

Wear sleeves

TYPE: Wear sleeves, SKF Speedi-Sleeve, Speedi-Sleeve (SKF)

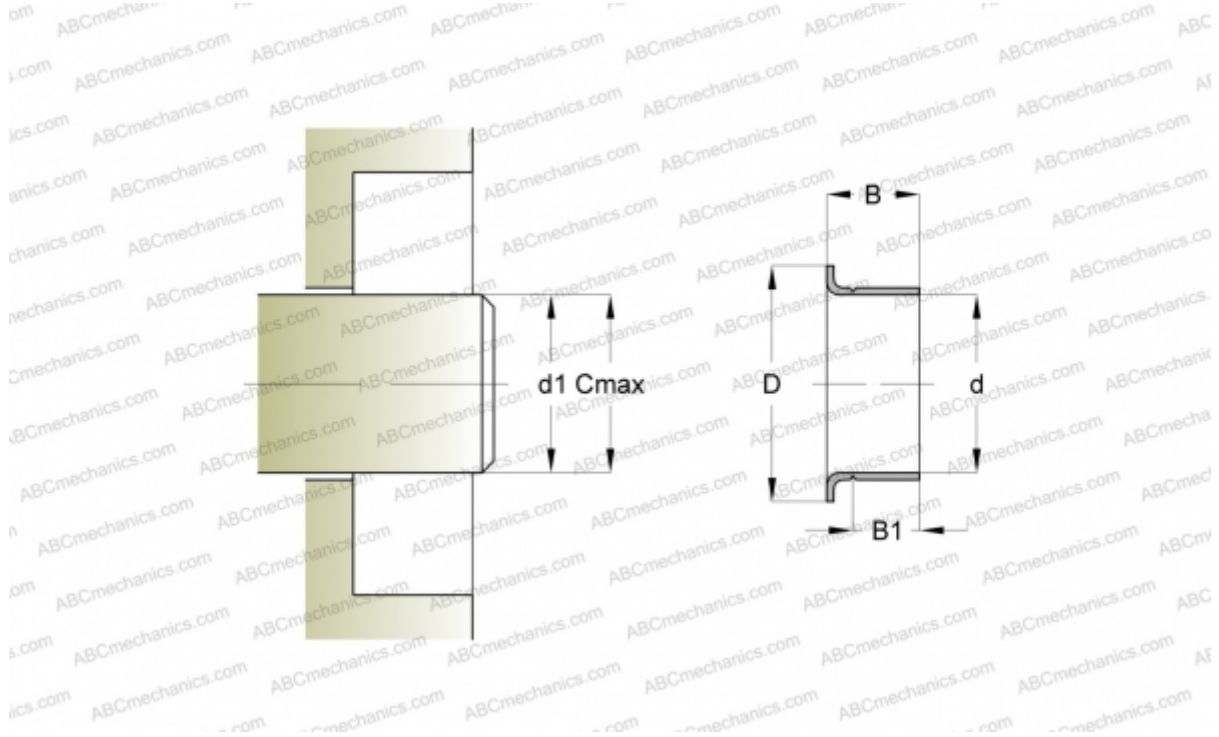

Technical specification

DIMENSIONS, MM

d1	74,600
d	74,630
D	84,940
B	16,280
B1	12,700
C	74,750

MANUFACTURER [SKF](#)

INTERCHANGE

CR [CR 99290](#)

CALCULATION DATA

Maximum shaft surface speed 0,001 m/s