

99293 SKF

Wear sleeves

TYPE: Wear sleeves, SKF Speedi-Sleeve, Speedi-Sleeve (SKF)

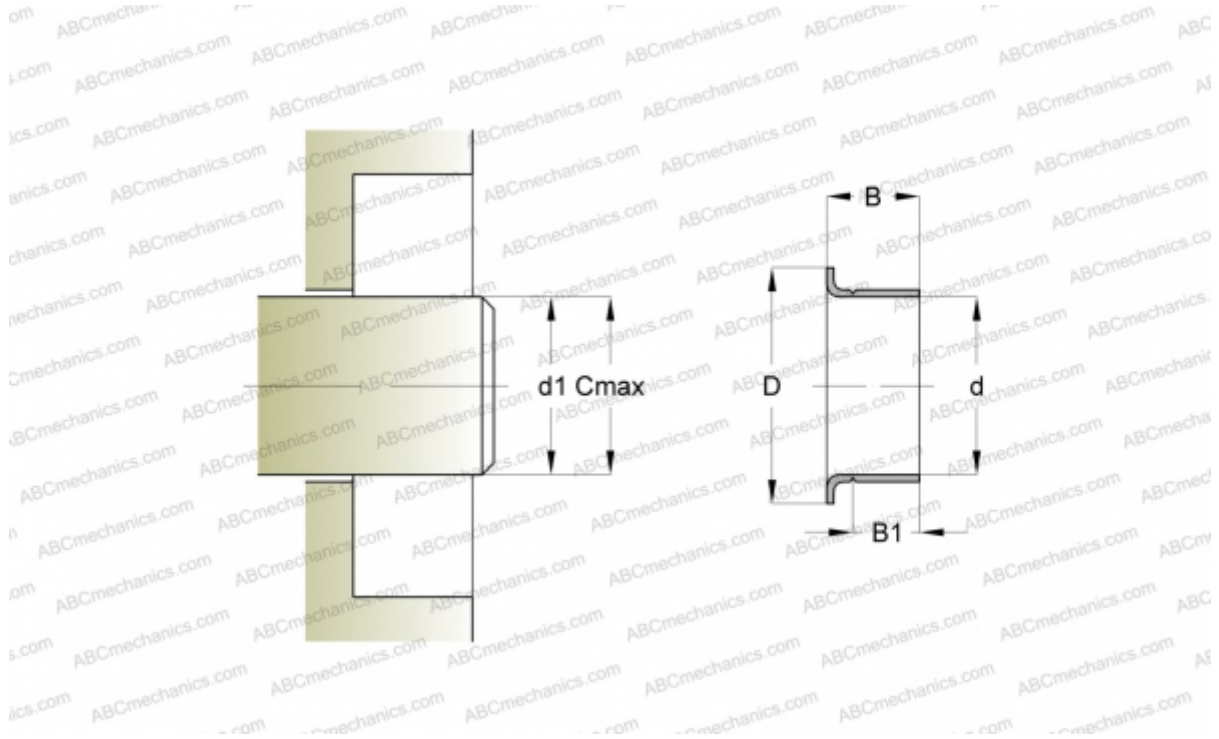

Technical specification

DIMENSIONS, MM

d1	74,600
d	74,680
D	84,940
B	23,830
B1	19,840
C	74,750

MANUFACTURER [SKF](#)

INTERCHANGE

CR [CR 99293](#)

CALCULATION DATA

Maximum shaft surface speed 0,001 m/s