

## CR 99293 CR

Wear sleeves

TYPE: Wear sleeves, SKF Speedi-Sleeve, Speedi-Sleeve (SKF)

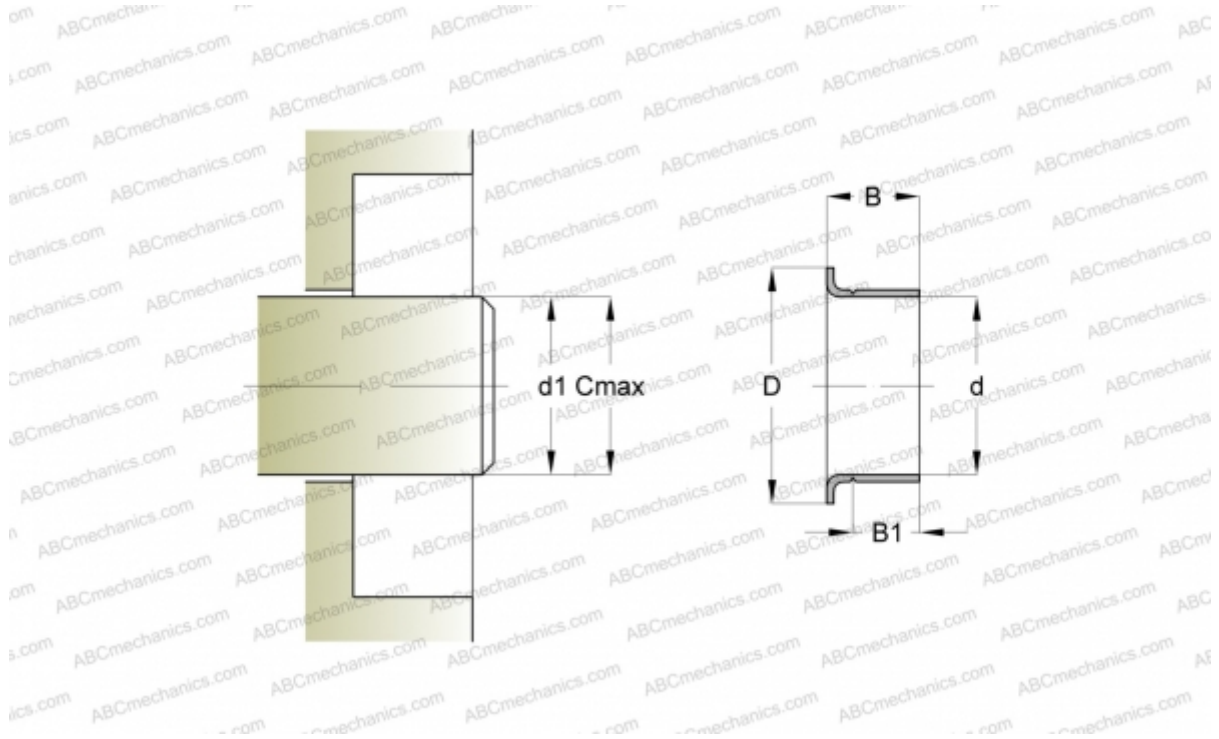

### Technical specification

#### DIMENSIONS, MM

|    |        |
|----|--------|
| d1 | 74,600 |
| d  | 74,680 |
| D  | 84,940 |
| B  | 23,830 |
| B1 | 19,840 |
| C  | 74,750 |

**MANUFACTURER** [CR](#)

#### INTERCHANGE

SKF [99293](#)

#### CALCULATION DATA

Maximum shaft surface speed 0,001 m/s