

## CR 99294 CR

Wear sleeves

TYPE: Wear sleeves, SKF Speedi-Sleeve, Speedi-Sleeve (SKF)

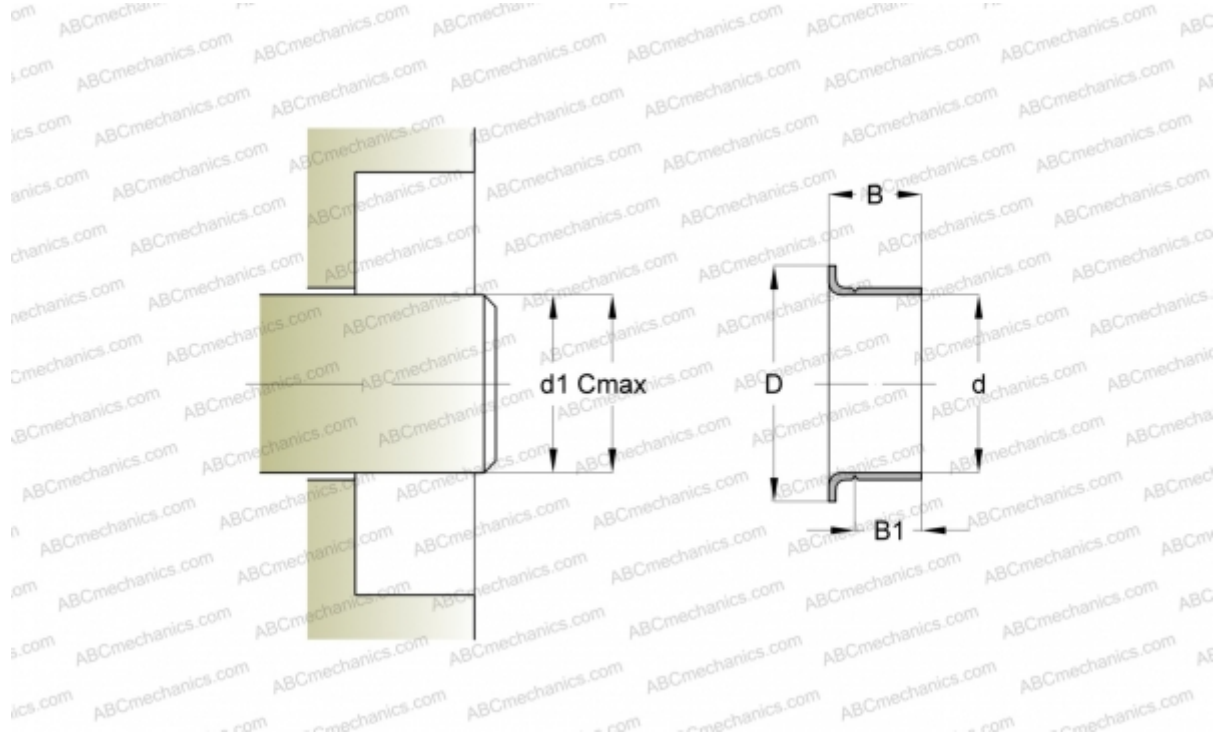

### Technical specification

#### DIMENSIONS, MM

d1	74,930
d	75,010
D	83,950
B	26,010
B1	22,000
C	75,080

**MANUFACTURER** [CR](#)

#### INTERCHANGE

SKF [99294](#)

#### CALCULATION DATA

Maximum shaft surface speed 0,001 m/s