

99291 SKF

Wear sleeves

TYPE: Wear sleeves, SKF Speedi-Sleeve, Speedi-Sleeve (SKF)

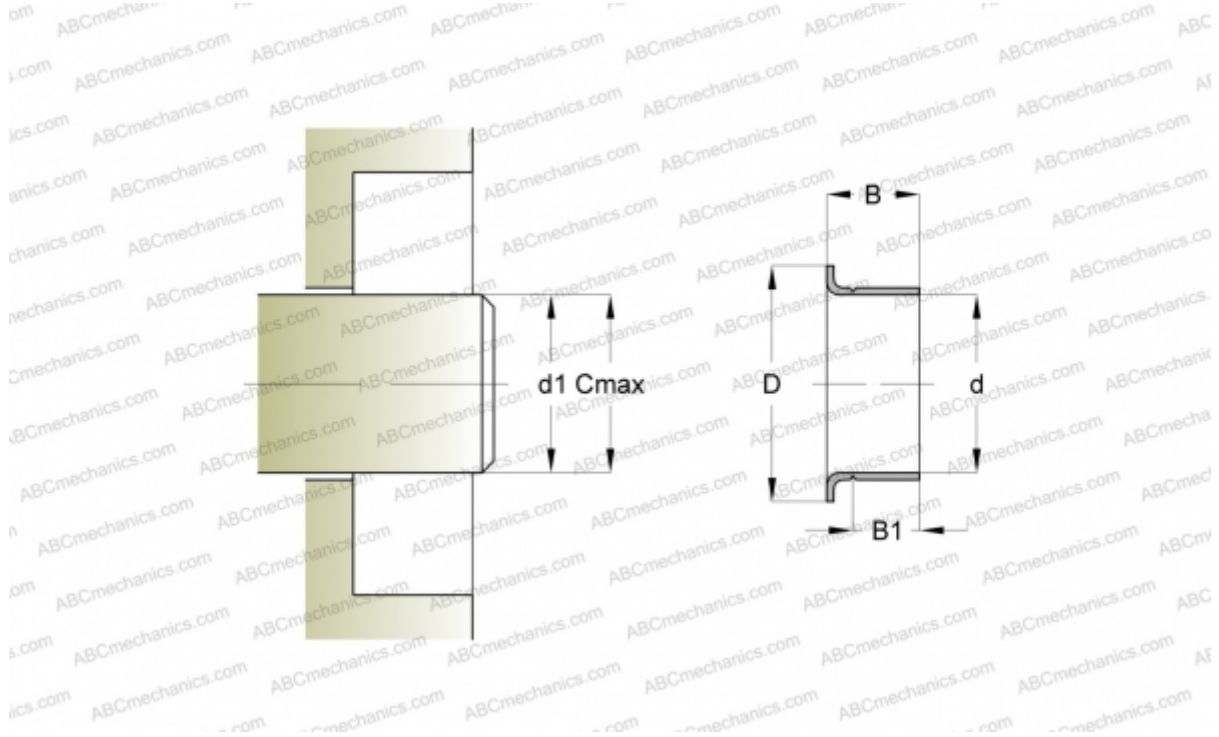

Technical specification

DIMENSIONS, MM

d1	75,950
d	76,200
D	85,320
B	15,880
B1	12,290
C	76,100

MANUFACTURER [SKF](#)

INTERCHANGE

CR [CR 99291](#)

CALCULATION DATA

Maximum shaft surface speed 0,001 m/s