

99386 SKF

Wear sleeves

TYPE: Wear sleeves, SKF Speedi-Sleeve, Speedi-Sleeve (SKF)

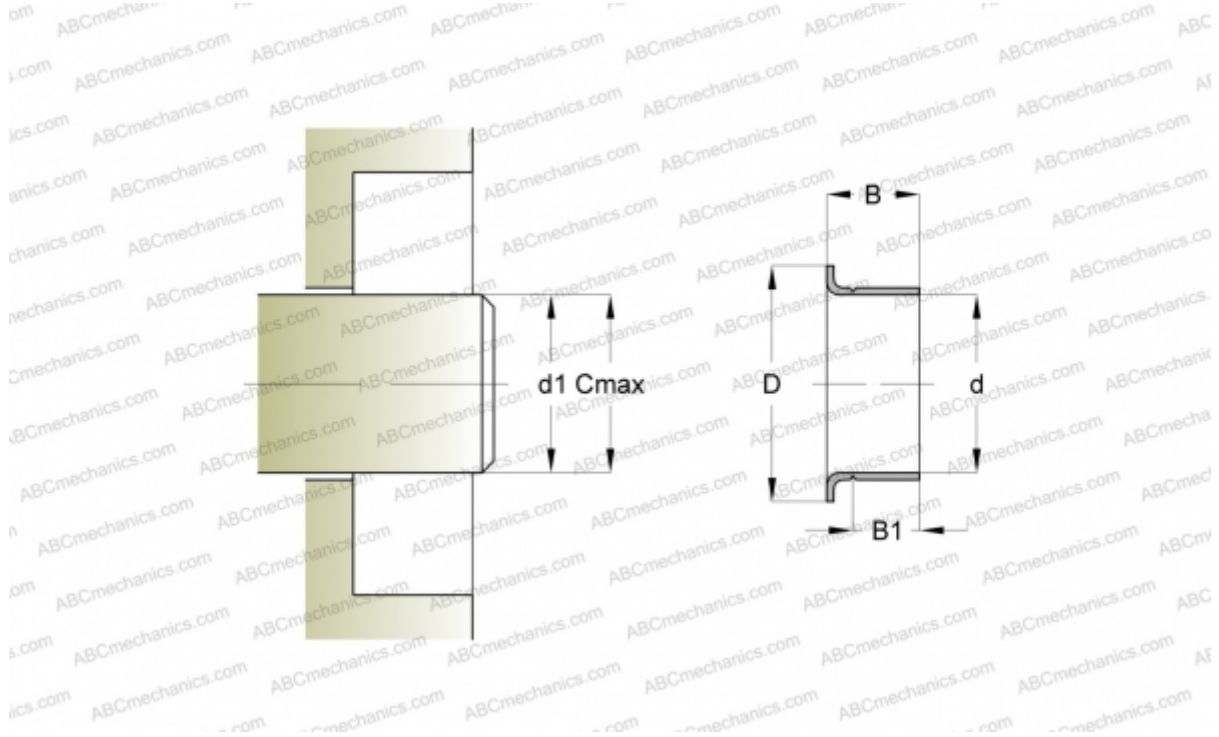

Technical specification

DIMENSIONS, MM

d1	98,250
d	98,320
D	106,300
B	25,400
B1	20,650
C	98,400

MANUFACTURER [SKF](#)

INTERCHANGE

CR [CR 99386](#)

CALCULATION DATA

Maximum shaft surface speed 0,001 m/s