

99463 SKF

Wear sleeves

TYPE: Wear sleeves, SKF Speedi-Sleeve, Speedi-Sleeve (SKF)

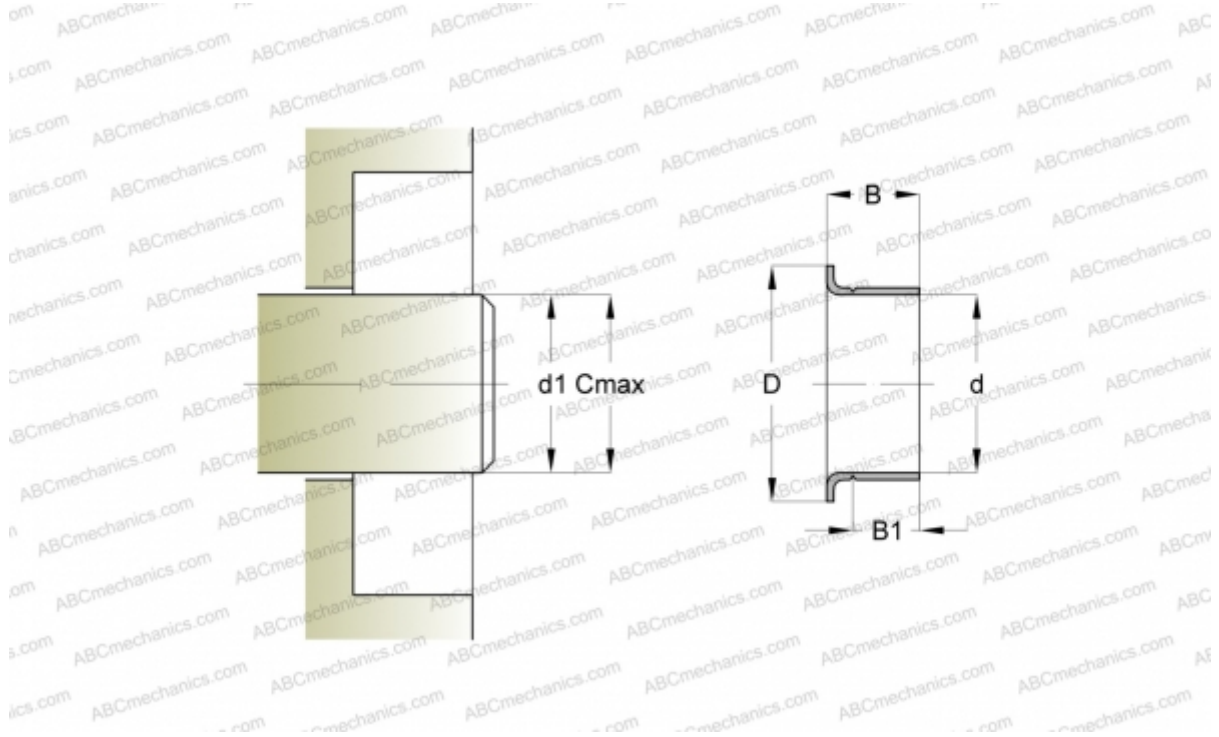

Technical specification

DIMENSIONS, MM

d1	117,370
d	117,480
D	128,600
B	31,750
B1	25,400
C	117,580

MANUFACTURER [SKF](#)

INTERCHANGE

CR [CR 99463](#)

CALCULATION DATA

Maximum shaft surface speed 0,001 m/s