

## CR 99560 CR

Wear sleeves

TYPE: Wear sleeves, SKF Speedi-Sleeve, Speedi-Sleeve (SKF)

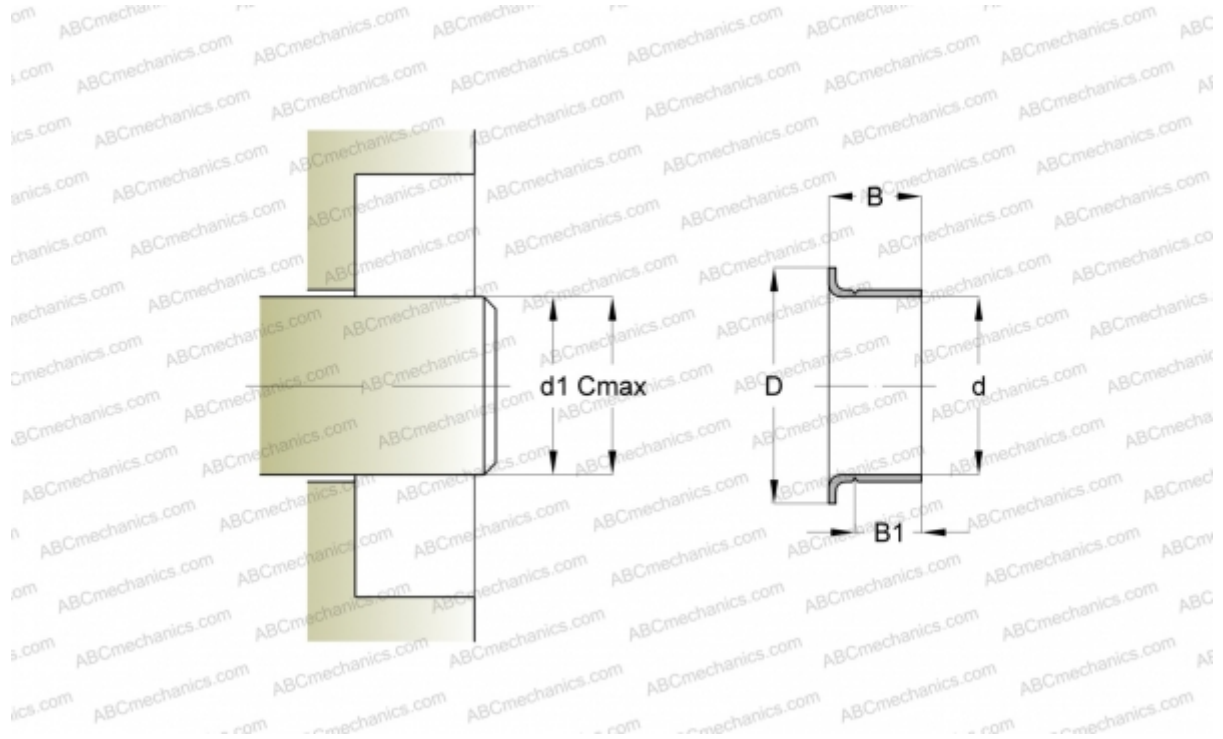

### Technical specification

#### DIMENSIONS, MM

d1	142,770
d	142,880
D	157,180
B	25,400
B1	22,230
C	142,980

**MANUFACTURER** [CR](#)

#### INTERCHANGE

SKF [99560](#)

#### CALCULATION DATA

Maximum shaft surface speed 0,001 m/s