

CR 99625 CR

Wear sleeves

TYPE: Wear sleeves, SKF Speedi-Sleeve, Speedi-Sleeve (SKF)

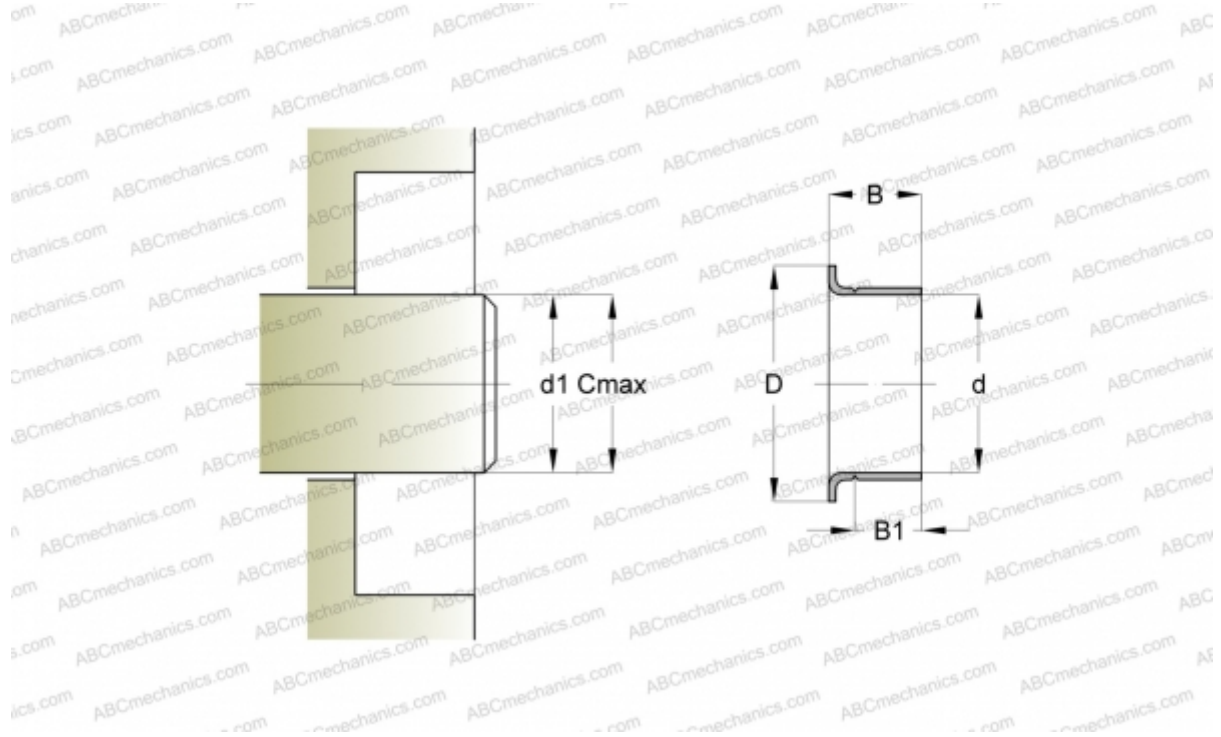

Technical specification

DIMENSIONS, MM

d1	158,620
d	158,750
D	168,280
B	31,750
B1	26,190
C	158,880

MANUFACTURER [CR](#)

INTERCHANGE

SKF [99625](#)

CALCULATION DATA

Maximum shaft surface speed 0,001 m/s