

99640 SKF

Wear sleeves

TYPE: Wear sleeves, SKF Speedi-Sleeve, Speedi-Sleeve (SKF)

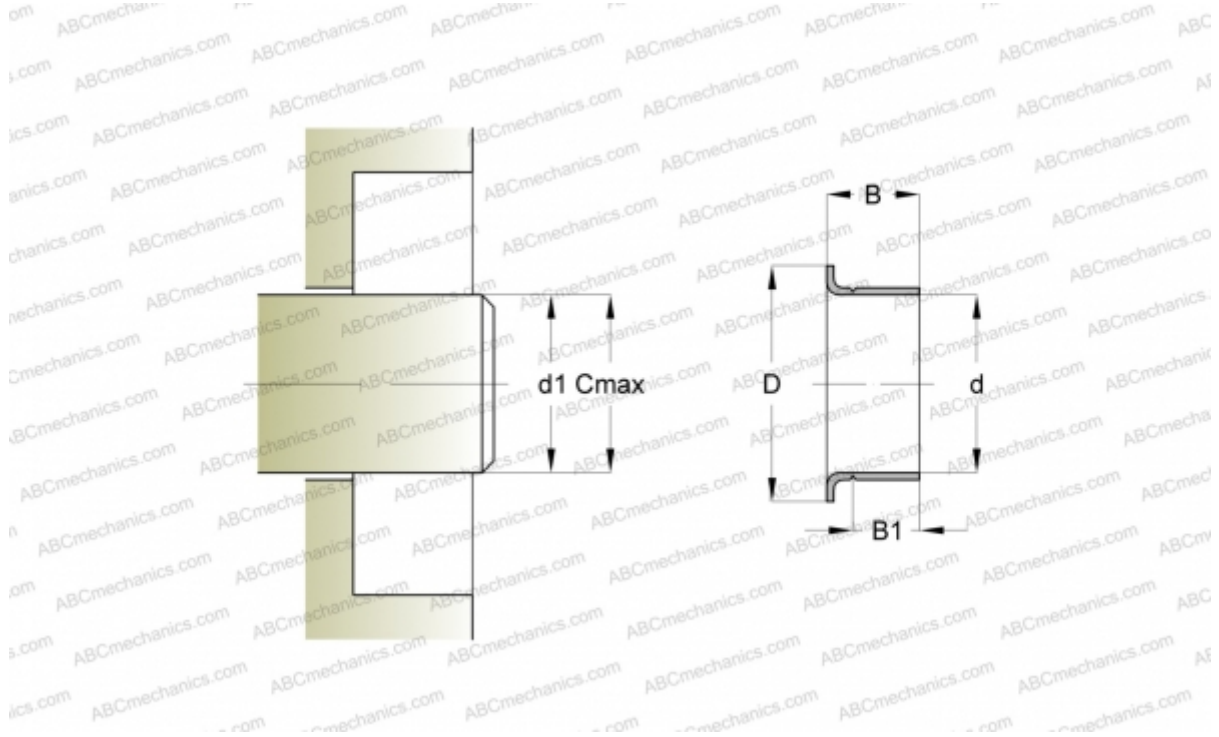

Technical specification

DIMENSIONS, MM

d1	169,750
d	169,880
D	182,580
B	38,000
B1	31,750
C	170,000

MANUFACTURER [SKF](#)

INTERCHANGE

CR [CR 99640](#)

CALCULATION DATA

Maximum shaft surface speed 0,001 m/s