

## 99860 SKF

Wear sleeves

TYPE: Wear sleeves, SKF Speedi-Sleeve, Speedi-Sleeve Gold, for heavy industrial applications (SKF)

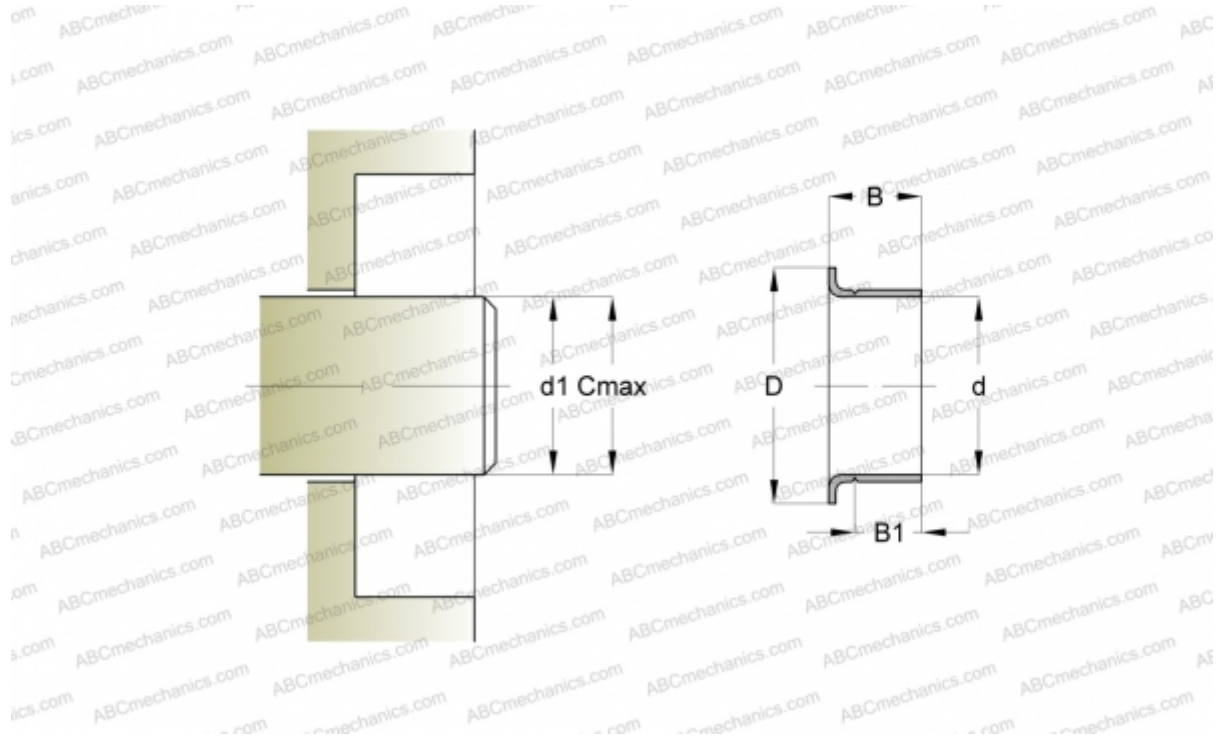

### Technical specification

#### DIMENSIONS, MM

d1	23,060
d	23,110
D	30,940
B	11,130
B1	7,950
C	23,160

**MANUFACTURER** [SKF](#)

#### INTERCHANGE

CR [CR 99860](#)

#### CALCULATION DATA

Maximum shaft surface speed 0,001 m/s