

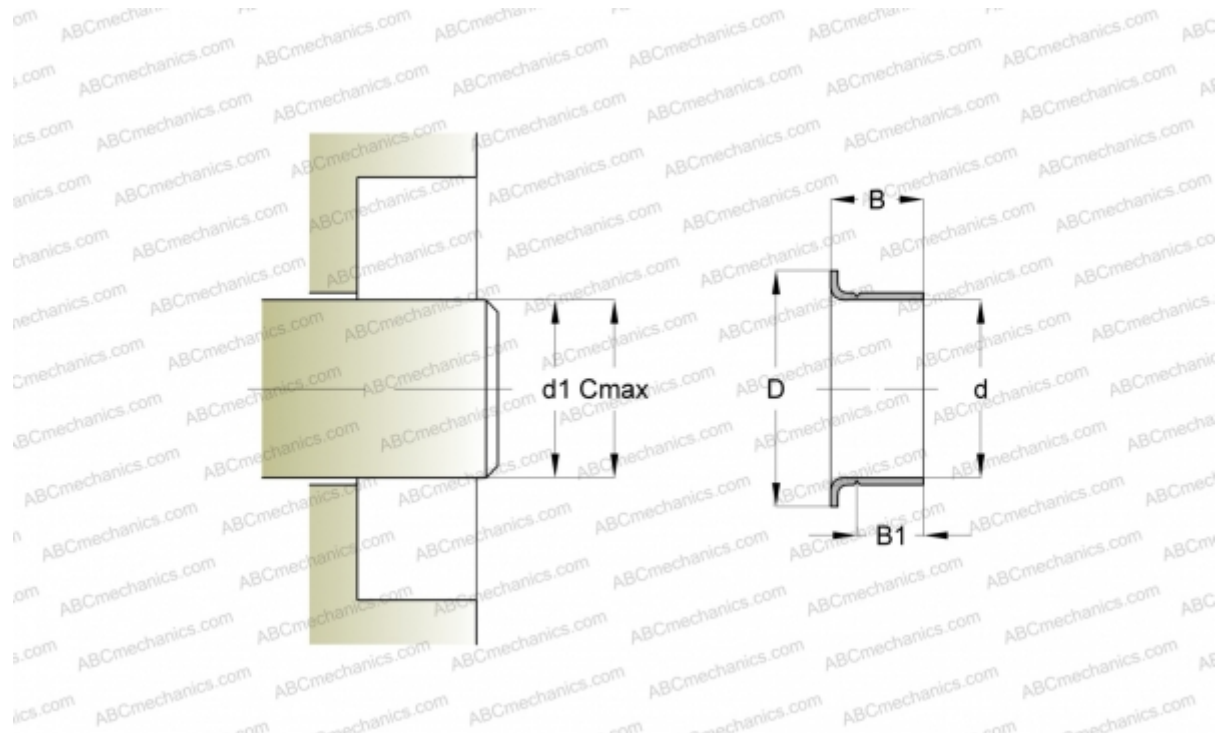

CR 99860 CR

Wear sleeves

TYPE: Wear sleeves, SKF Speedi-Sleeve, Speedi-Sleeve Gold, for heavy industrial applications (SKF)



Technical specification

DIMENSIONS, MM

d1	23,060
d	23,110
D	30,940
B	11,130
B1	7,950
C	23,160

MANUFACTURER [CR](#)

INTERCHANGE

SKF	99860
-----	-----------------------

CALCULATION DATA

Maximum shaft surface speed	0,001 m/s
-----------------------------	-----------

