

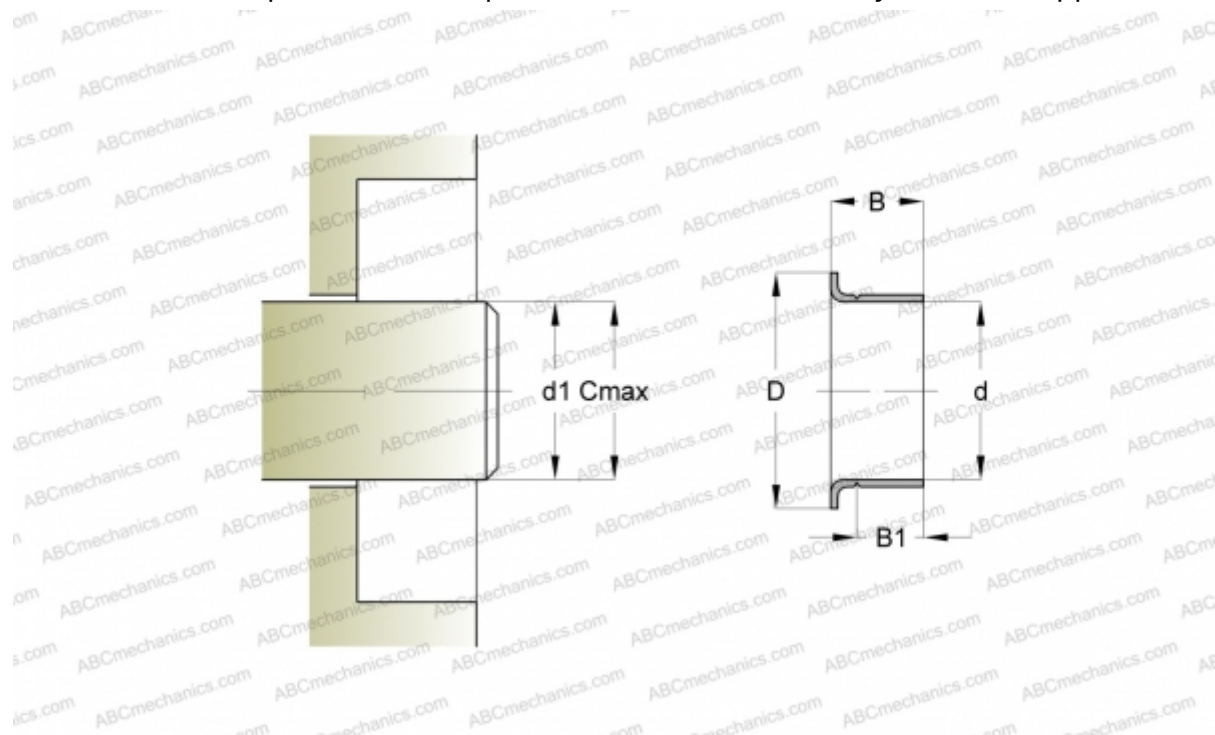

99813 SKF

Wear sleeves

TYPE: Wear sleeves, SKF Speedi-Sleeve, Speedi-Sleeve Gold, for heavy industrial applications (SKF)



Technical specification

DIMENSIONS, MM

d1	24,940
d	24,990
D	33,020
B	11,000
B1	7,950
C	25,040

MANUFACTURER

[SKF](#)

INTERCHANGE

CR	CR 99813
----	--------------------------

CALCULATION DATA

Maximum shaft surface speed	0,001 m/s
-----------------------------	-----------

