

99814 SKF

Wear sleeves

TYPE: Wear sleeves, SKF Speedi-Sleeve, Speedi-Sleeve Gold, for heavy industrial applications (SKF)

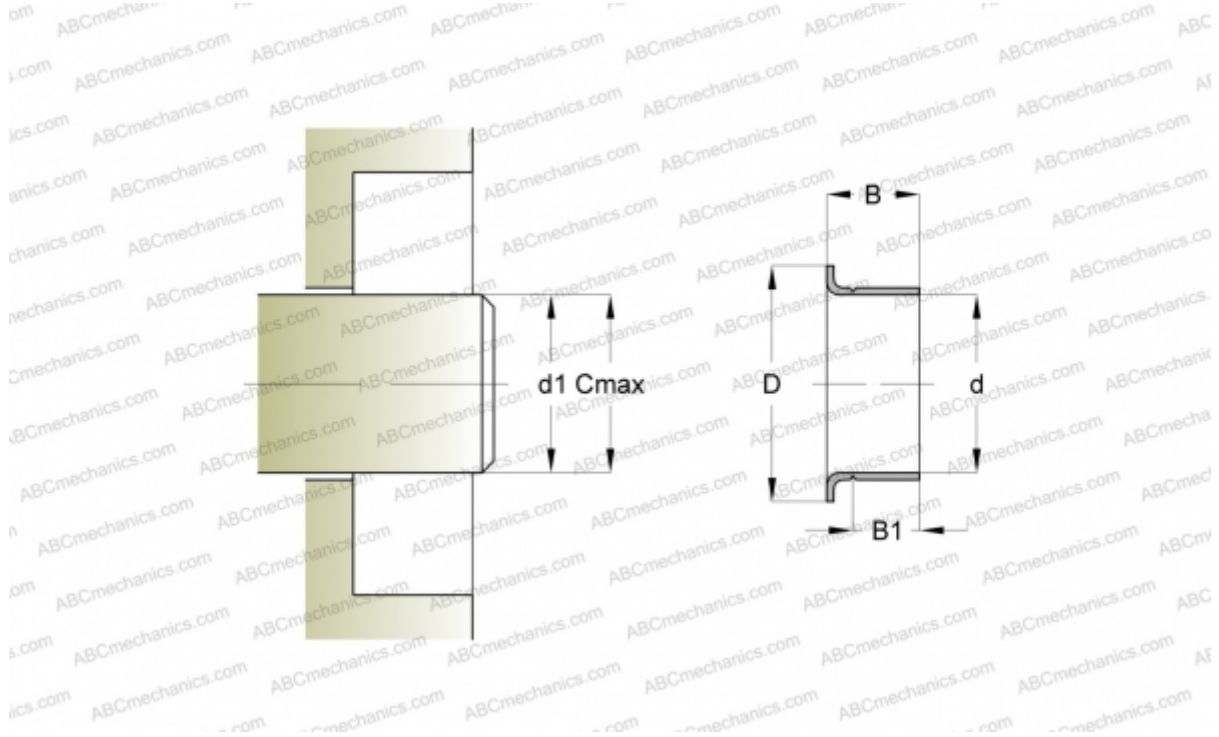

Technical specification

DIMENSIONS, MM

d1	25,350
d	25,400
D	30,960
B	11,130
B1	7,950
C	25,450

MANUFACTURER [SKF](#)

INTERCHANGE

CR [CR 99814](#)

CALCULATION DATA

Maximum shaft surface speed 0,001 m/s