

## CR 99814 CR

Wear sleeves

TYPE: Wear sleeves, SKF Speedi-Sleeve, Speedi-Sleeve Gold, for heavy industrial applications (SKF)

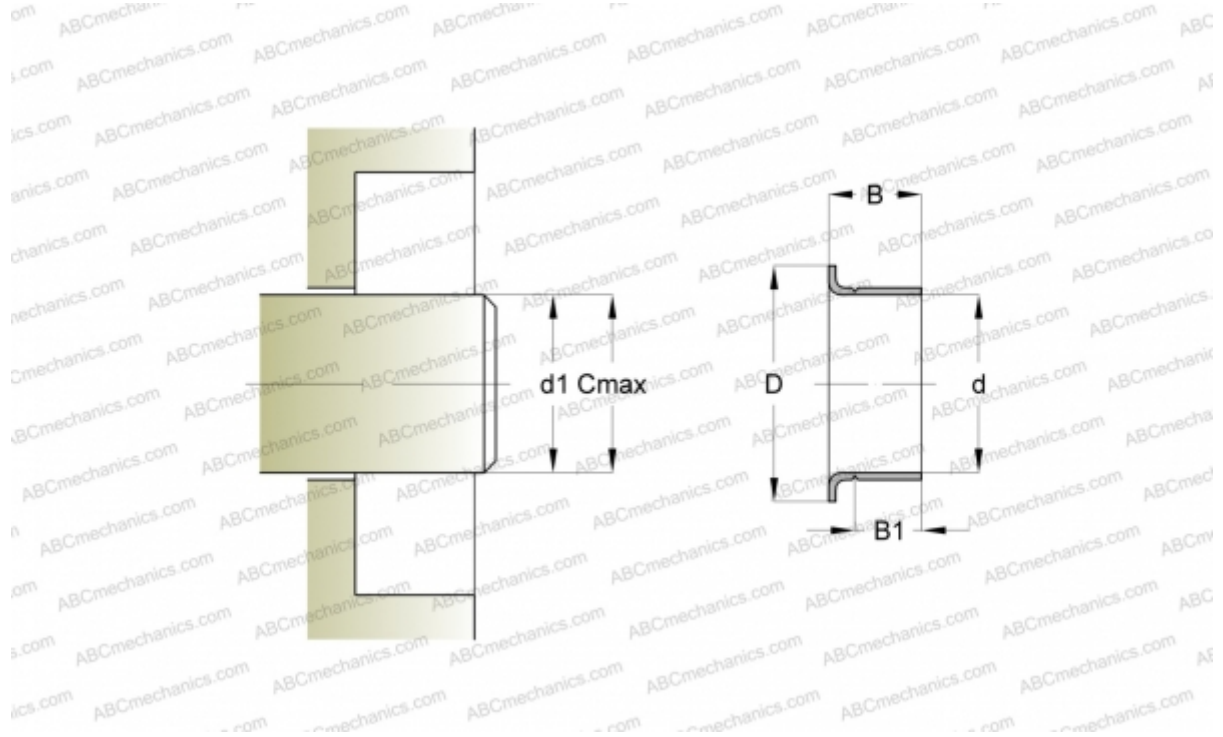

### Technical specification

#### DIMENSIONS, MM

d1	25,350
d	25,400
D	30,960
B	11,130
B1	7,950
C	25,450

**MANUFACTURER** [CR](#)

#### INTERCHANGE

SKF [99814](#)

#### CALCULATION DATA

Maximum shaft surface speed 0,001 m/s