

99815 SKF

Wear sleeves

TYPE: Wear sleeves, SKF Speedi-Sleeve, Speedi-Sleeve Gold, for heavy industrial applications (SKF)

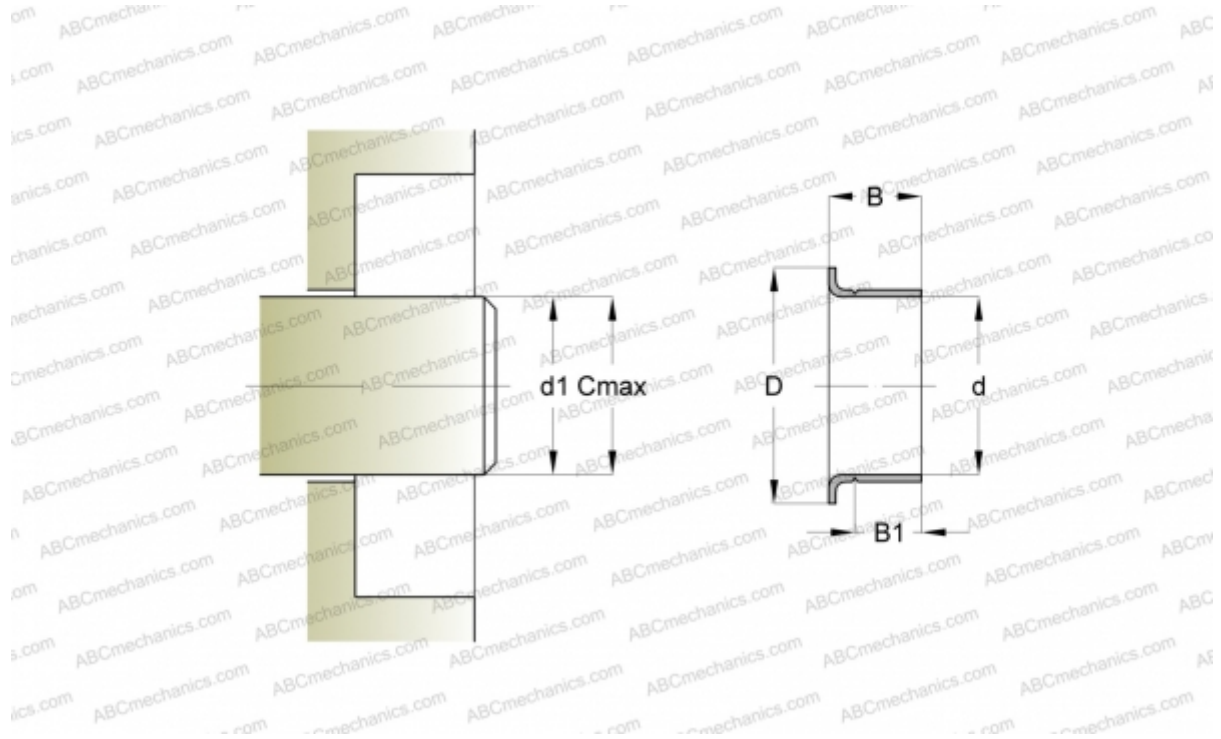

Technical specification

DIMENSIONS, MM

d1	26,920
d	27,000
D	33,530
B	11,130
B1	7,950
C	27,030

MANUFACTURER

[SKF](#)

INTERCHANGE

CR	CR 99815
----	--------------------------

CALCULATION DATA

Maximum shaft surface speed	0,001 m/s
-----------------------------	-----------