

CR 99866 CR

Wear sleeves

TYPE: Wear sleeves, SKF Speedi-Sleeve, Speedi-Sleeve Gold, for heavy industrial applications (SKF)

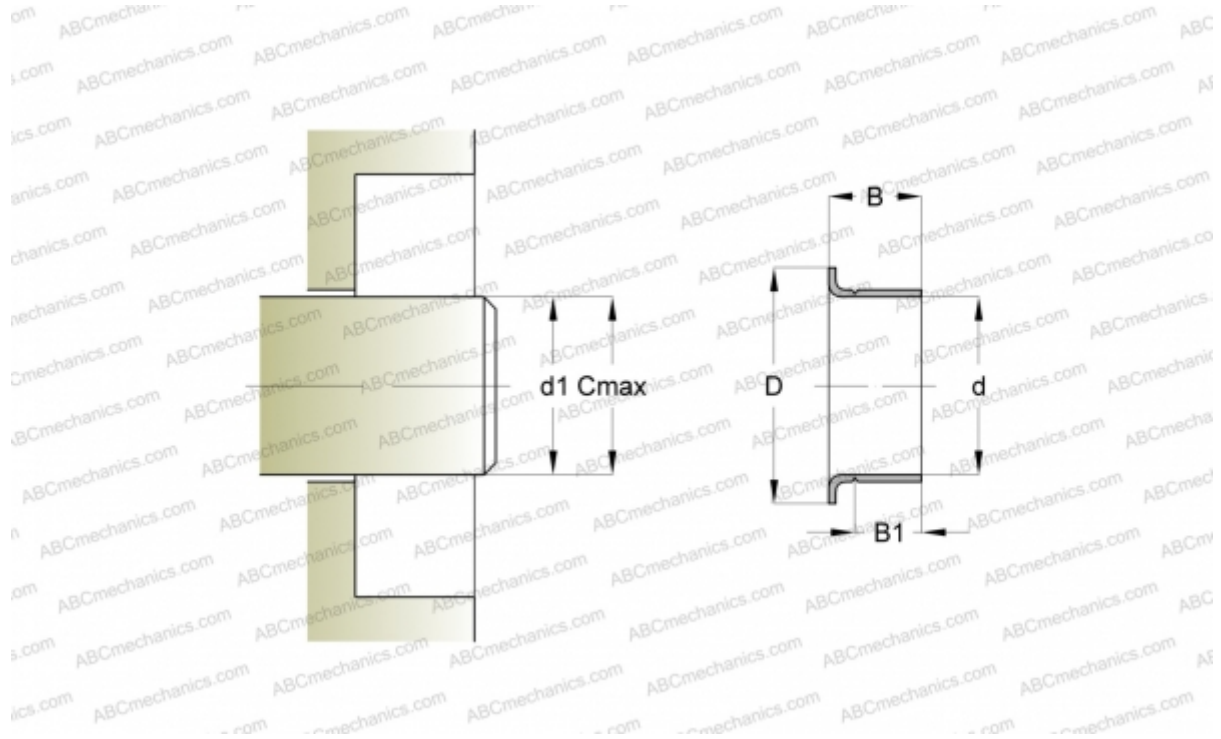

Technical specification

DIMENSIONS, MM

d1	27,940
d	27,990
D	34,930
B	12,700
B1	9,530
C	28,040

MANUFACTURER

[CR](#)

INTERCHANGE

SKF	99866
-----	-----------------------

CALCULATION DATA

Maximum shaft surface speed	0,001 m/s
-----------------------------	-----------