

## CR 99816 CR

Wear sleeves

TYPE: Wear sleeves, SKF Speedi-Sleeve, Speedi-Sleeve Gold, for heavy industrial applications (SKF)

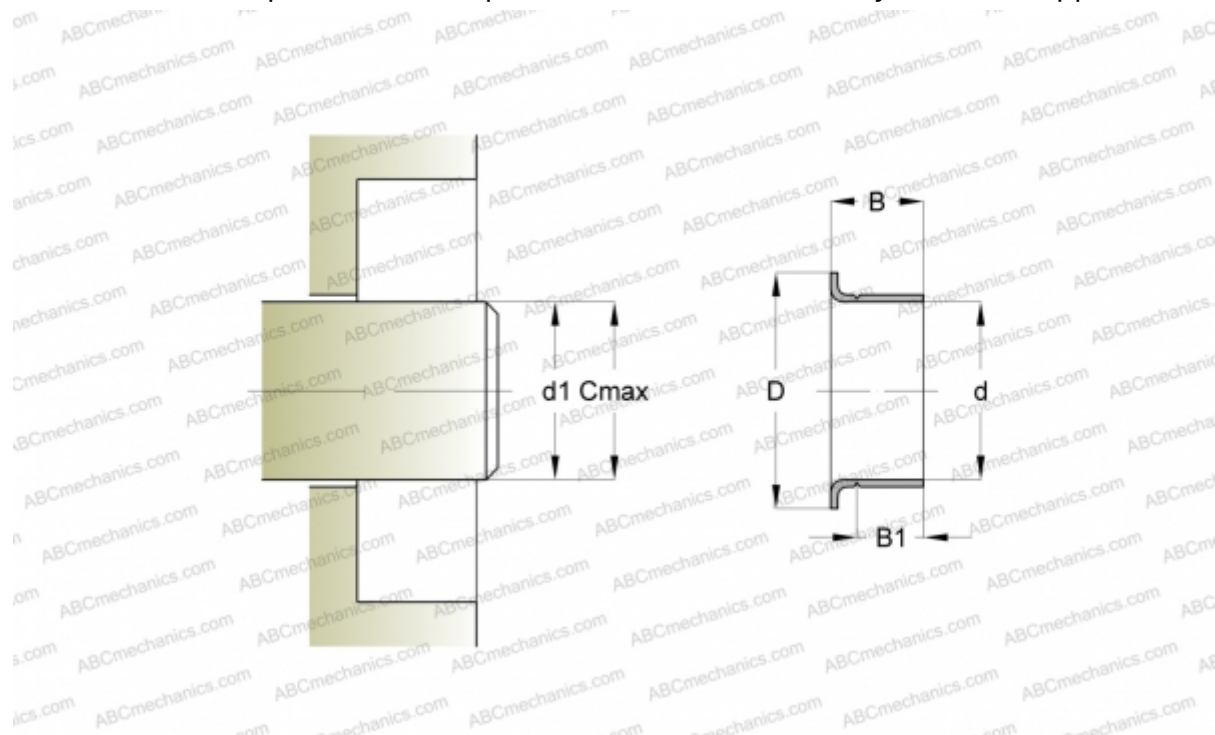

### Technical specification

#### DIMENSIONS, MM

d1	28,520
d	28,580
D	38,100
B	11,130
B1	7,950
C	28,630

#### MANUFACTURER

[CR](#)

#### INTERCHANGE

SKF	<a href="#">99816</a>
-----	-----------------------

#### CALCULATION DATA

Maximum shaft surface speed	0,001 m/s
-----------------------------	-----------