

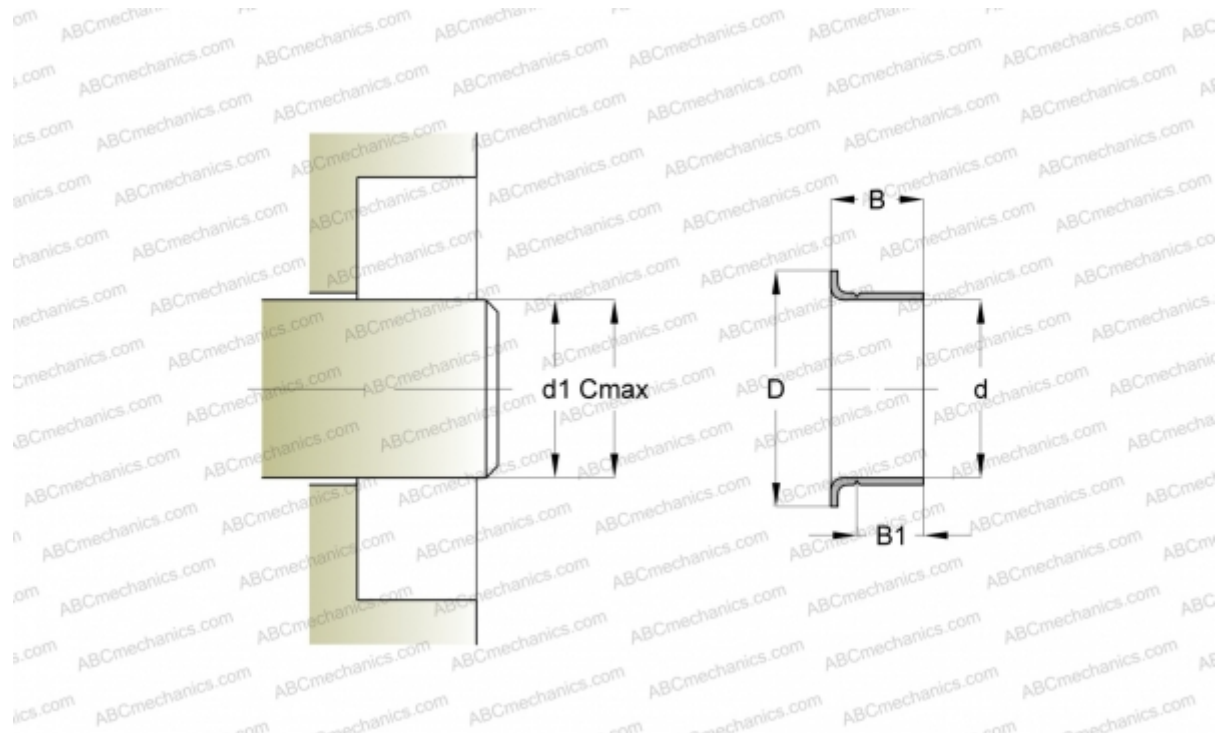

## 99817 SKF

Wear sleeves

TYPE: Wear sleeves, SKF Speedi-Sleeve, Speedi-Sleeve Gold, for heavy industrial applications (SKF)



### Technical specification

#### DIMENSIONS, MM

$d1$	31,670
$d$	31,750
$D$	38,100
$B$	11,130
$B1$	7,950
$C$	31,830

#### MANUFACTURER

[SKF](#)

#### INTERCHANGE

CR	<a href="#">CR 99817</a>
----	--------------------------

#### CALCULATION DATA

Maximum shaft surface speed	0,001 m/s
-----------------------------	-----------

