

## 99819 SKF

Wear sleeves

TYPE: Wear sleeves, SKF Speedi-Sleeve, Speedi-Sleeve Gold, for heavy industrial applications (SKF)

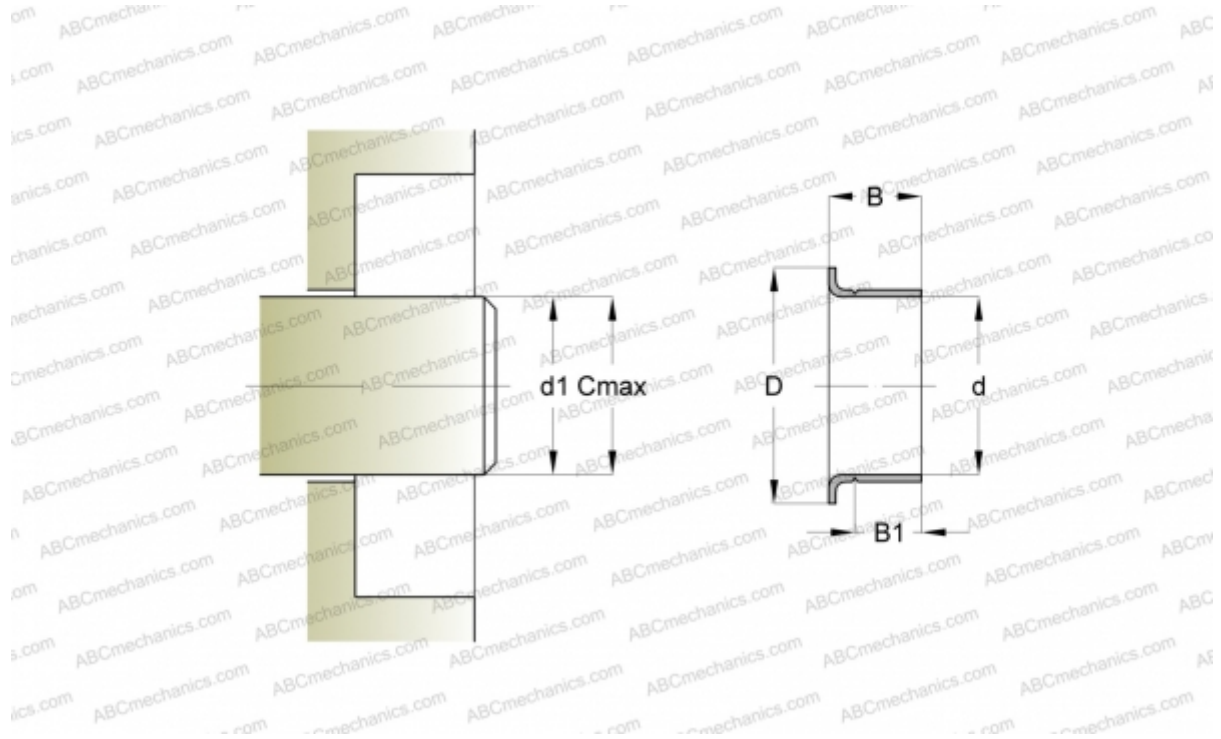

### Technical specification

#### DIMENSIONS, MM

d1	34,820
d	34,930
D	41,610
B	15,880
B1	12,700
C	34,980

#### MANUFACTURER

[SKF](#)

#### INTERCHANGE

CR	<a href="#">CR 99819</a>
----	--------------------------

#### CALCULATION DATA

Maximum shaft surface speed	0,001 m/s
-----------------------------	-----------