

CR 99819 CR

Wear sleeves

TYPE: Wear sleeves, SKF Speedi-Sleeve, Speedi-Sleeve Gold, for heavy industrial applications (SKF)

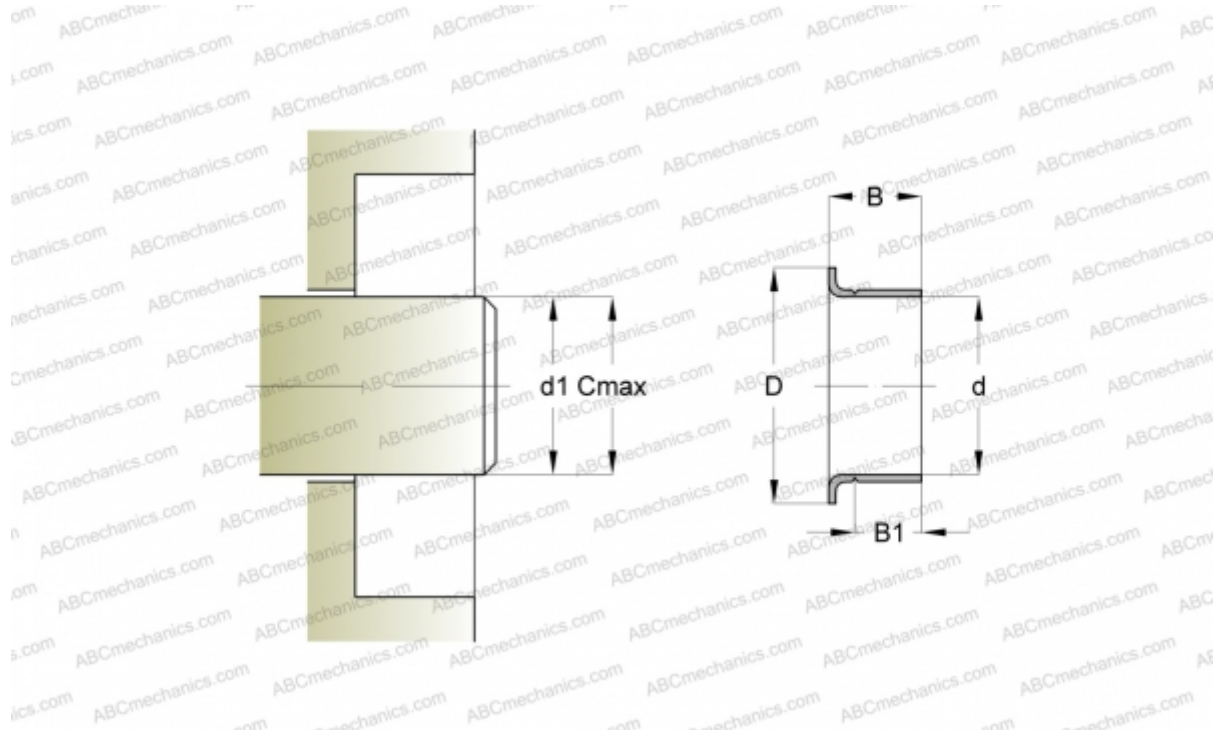

Technical specification

DIMENSIONS, MM

d1	34,820
d	34,930
D	41,610
B	15,880
B1	12,700
C	34,980

MANUFACTURER

[CR](#)

INTERCHANGE

SKF	99819
-----	-----------------------

CALCULATION DATA

Maximum shaft surface speed	0,001 m/s
-----------------------------	-----------