

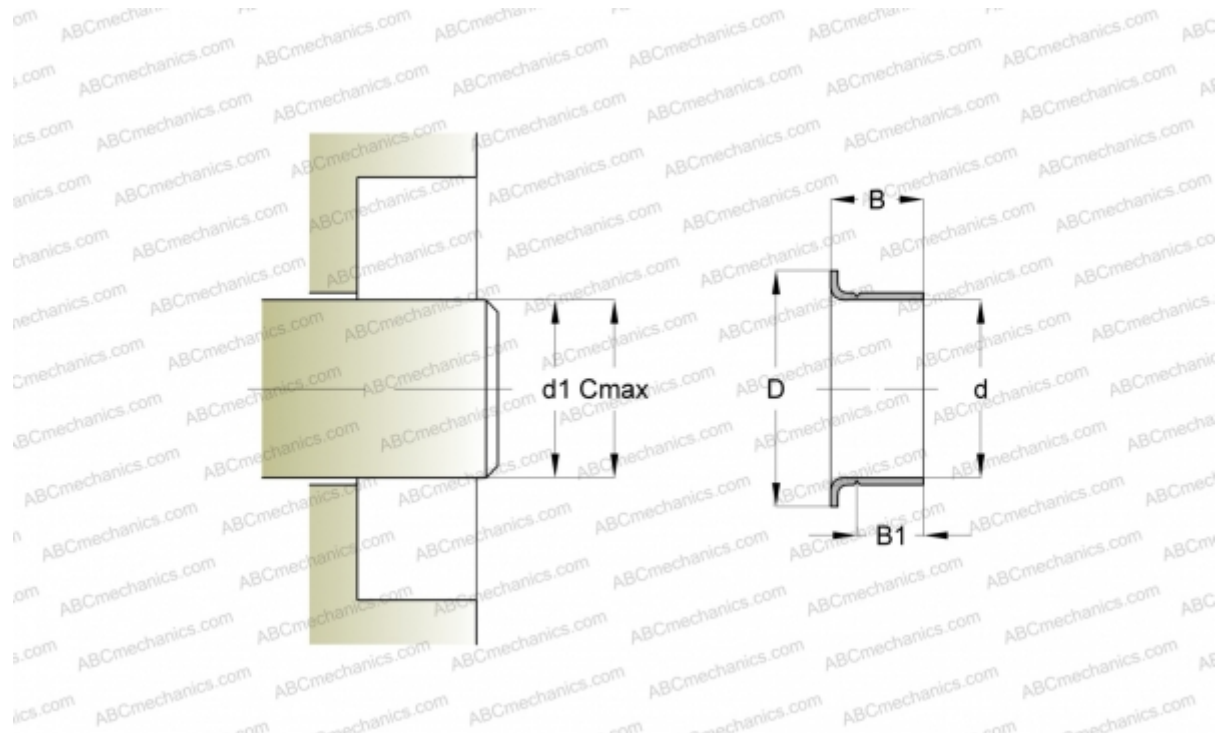

## CR 99823 CR

Wear sleeves

TYPE: Wear sleeves, SKF Speedi-Sleeve, Speedi-Sleeve Gold, for heavy industrial applications (SKF)



### Technical specification

#### DIMENSIONS, MM

d1	38,020
d	38,100
D	45,240
B	12,700
B1	9,530
C	38,180

MANUFACTURER [CR](#)

#### INTERCHANGE

SKF	<a href="#">99823</a>
-----	-----------------------

#### CALCULATION DATA

Maximum shaft surface speed	0,001 m/s
-----------------------------	-----------

