

## 99825 SKF

Wear sleeves

TYPE: Wear sleeves, SKF Speedi-Sleeve, Speedi-Sleeve Gold, for heavy industrial applications (SKF)

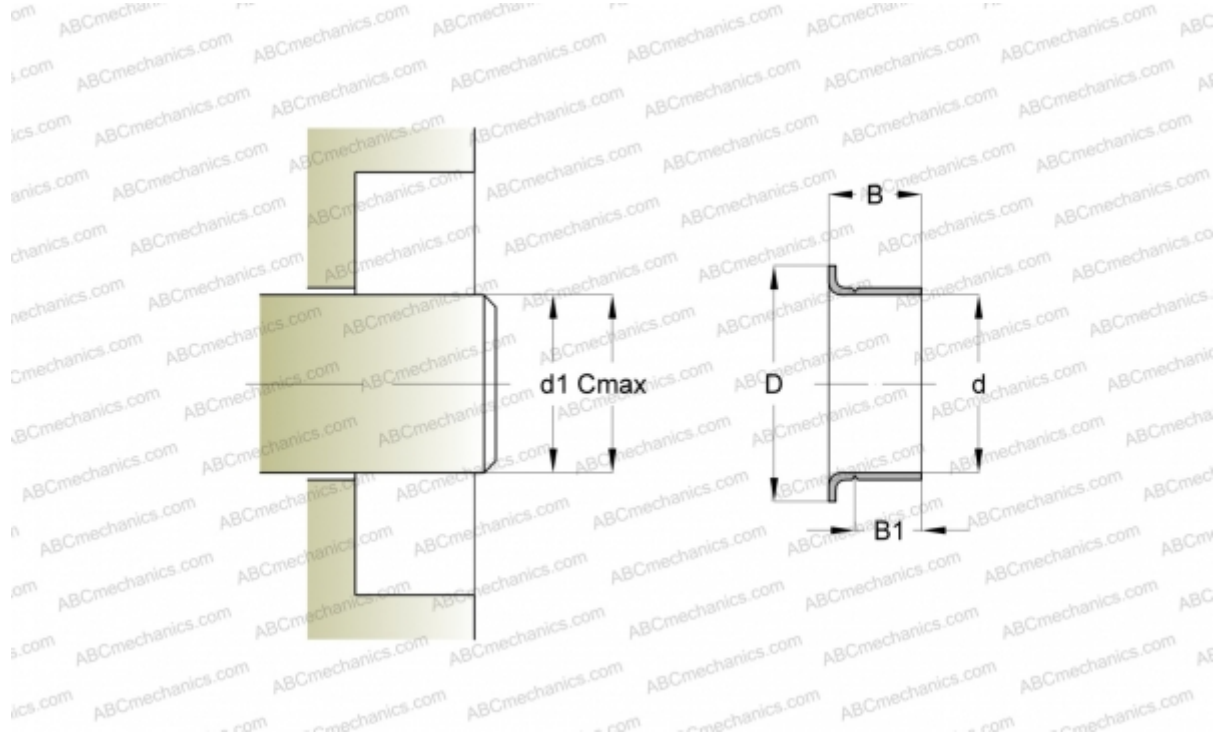

### Technical specification

#### DIMENSIONS, MM

d1	39,930
d	40,080
D	46,990
B	16,000
B1	13,000
C	40,080

**MANUFACTURER** [SKF](#)

#### INTERCHANGE

CR [CR 99825](#)

#### CALCULATION DATA

Maximum shaft surface speed 0,001 m/s