

## CR 99826 CR

Wear sleeves

TYPE: Wear sleeves, SKF Speedi-Sleeve, Speedi-Sleeve Gold, for heavy industrial applications (SKF)

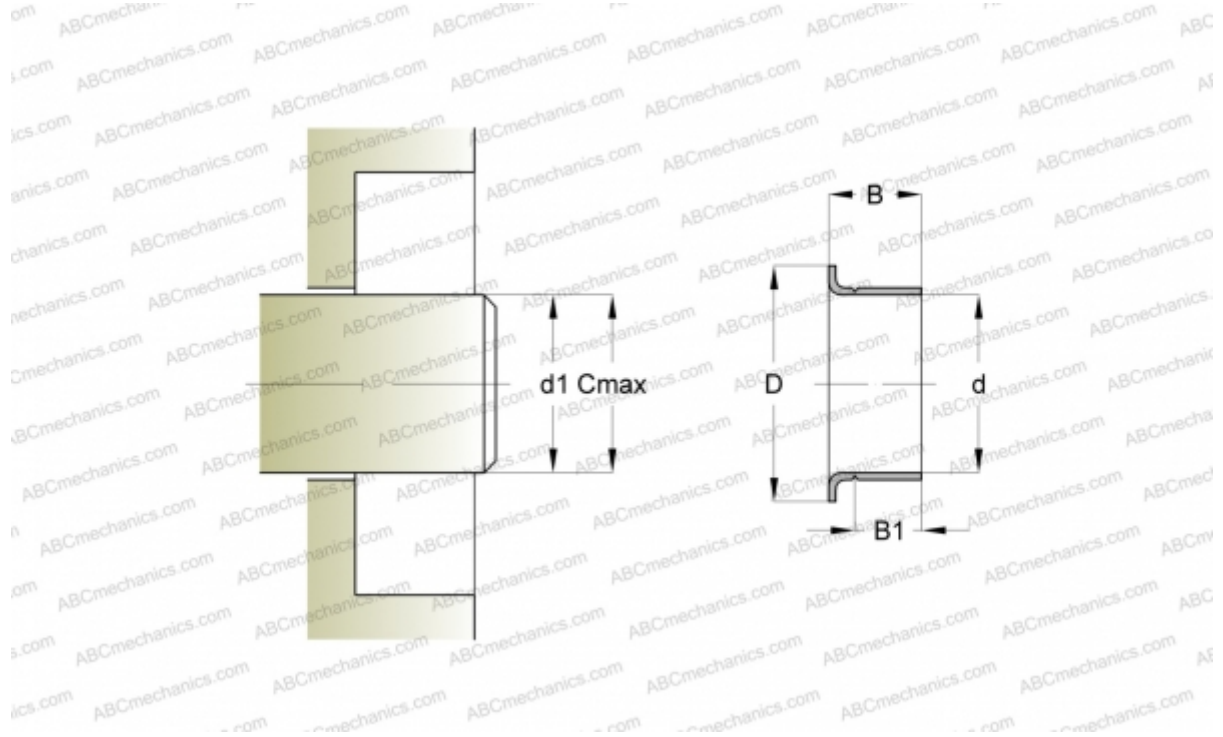

### Technical specification

#### DIMENSIONS, MM

d1	41,200
d	41,280
D	47,630
B	17,480
B1	14,300
C	41,350

**MANUFACTURER** [CR](#)

#### INTERCHANGE

SKF [99826](#)

#### CALCULATION DATA

Maximum shaft surface speed 0,001 m/s