

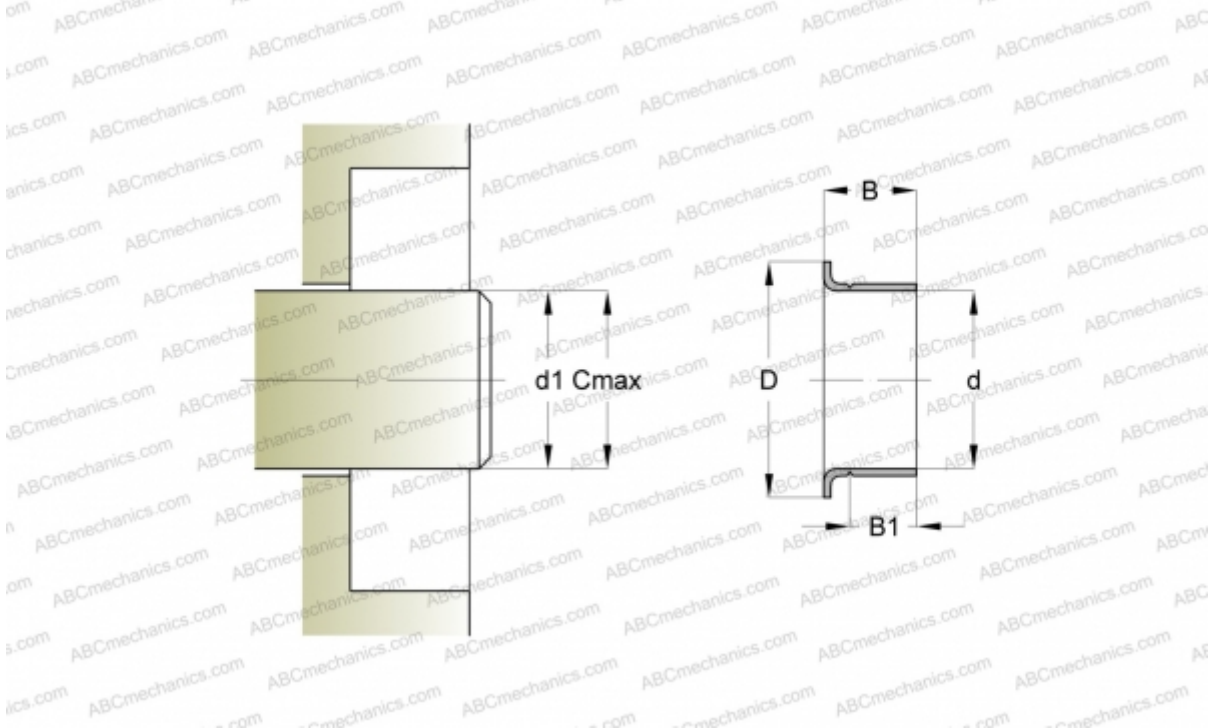

CR 99829 CR

Wear sleeves

TYPE: Wear sleeves, SKF Speedi-Sleeve, Speedi-Sleeve Gold, for heavy industrial applications (SKF)



Technical specification

DIMENSIONS, MM	
d1	44,730
d	44,860
D	52,400
B	17,480
B1	14,300
C	44,880
MANUFACTURER	
CR	
INTERCHANGE	
SKF	99829
CALCULATION DATA	
Maximum shaft surface speed	0,001 m/s

