

## CR 99831 CR

Wear sleeves

TYPE: Wear sleeves, SKF Speedi-Sleeve, Speedi-Sleeve Gold, for heavy industrial applications (SKF)

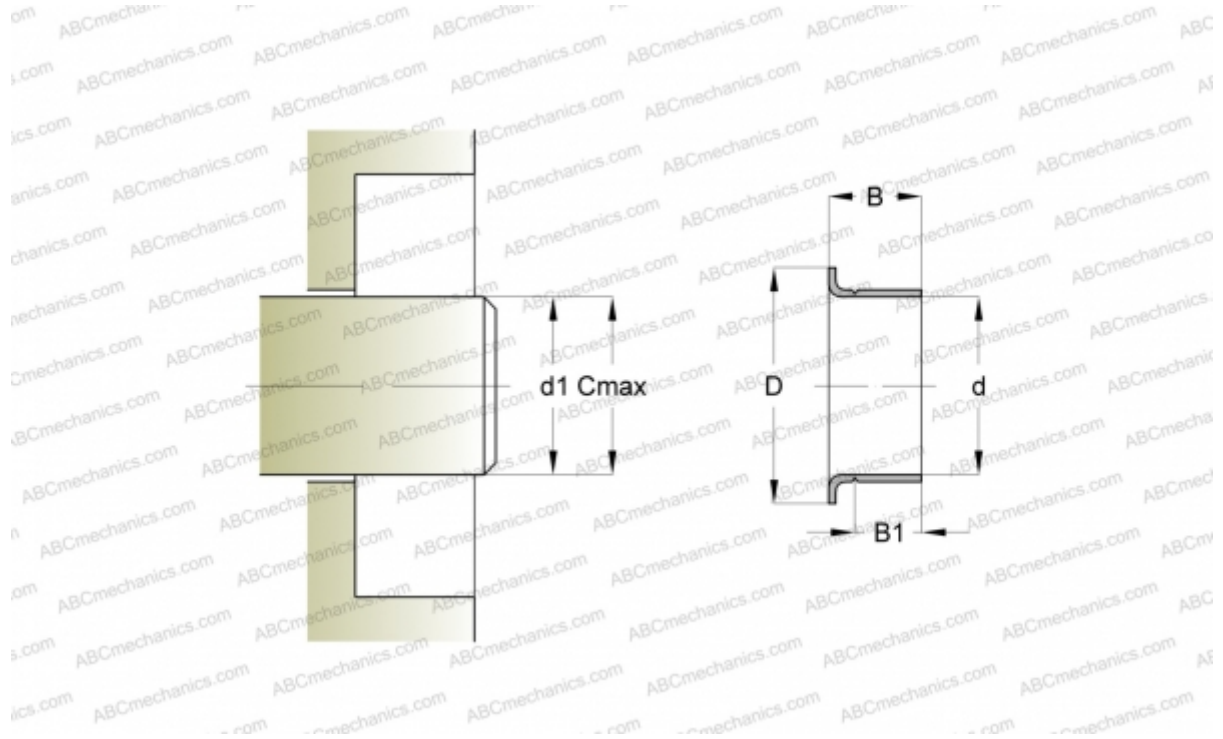

### Technical specification

#### DIMENSIONS, MM

d1	45,950
d	46,050
D	53,090
B	17,480
B1	14,300
C	46,100

**MANUFACTURER** [CR](#)

#### INTERCHANGE

SKF [99831](#)

#### CALCULATION DATA

Maximum shaft surface speed 0,001 m/s