

99832 SKF

Wear sleeves

TYPE: Wear sleeves, SKF Speedi-Sleeve, Speedi-Sleeve Gold, for heavy industrial applications (SKF)

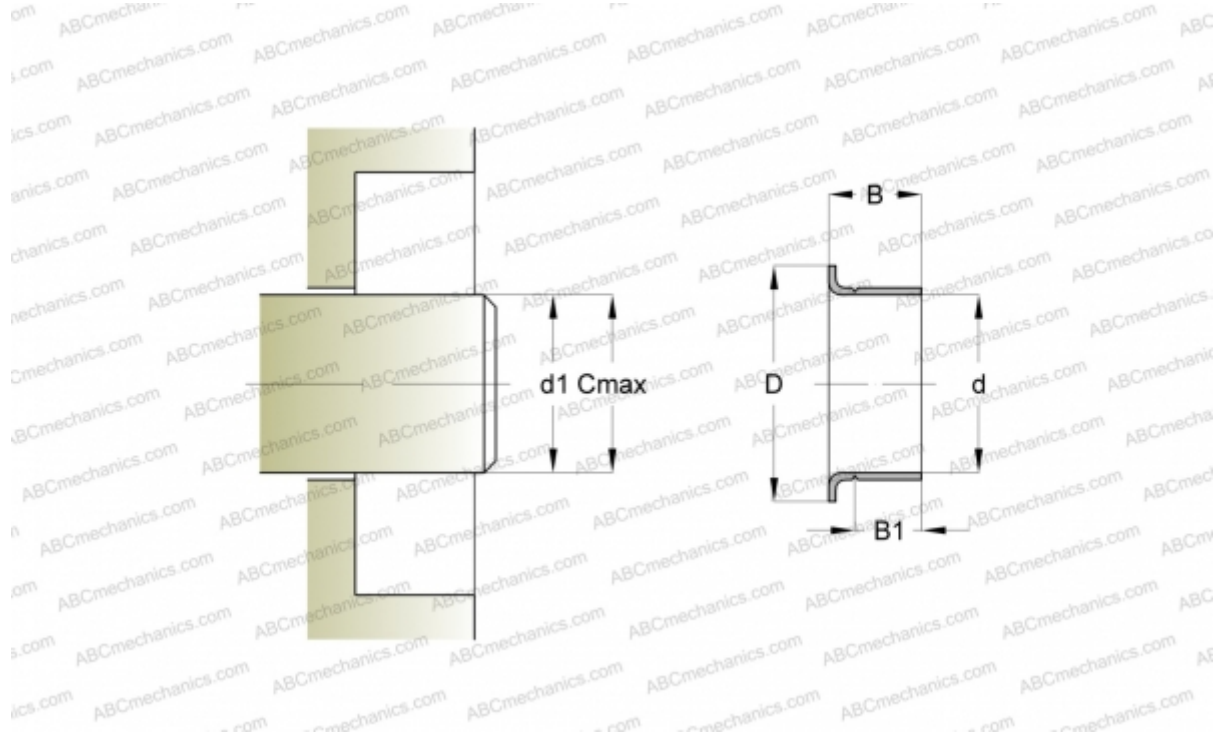

Technical specification

DIMENSIONS, MM

d_1	47,550
d	47,630
D	55,960
B	17,480
B_1	14,300
C	47,700

MANUFACTURER [SKF](#)

INTERCHANGE

CR [CR 99832](#)

CALCULATION DATA

Maximum shaft surface speed 0,001 m/s