

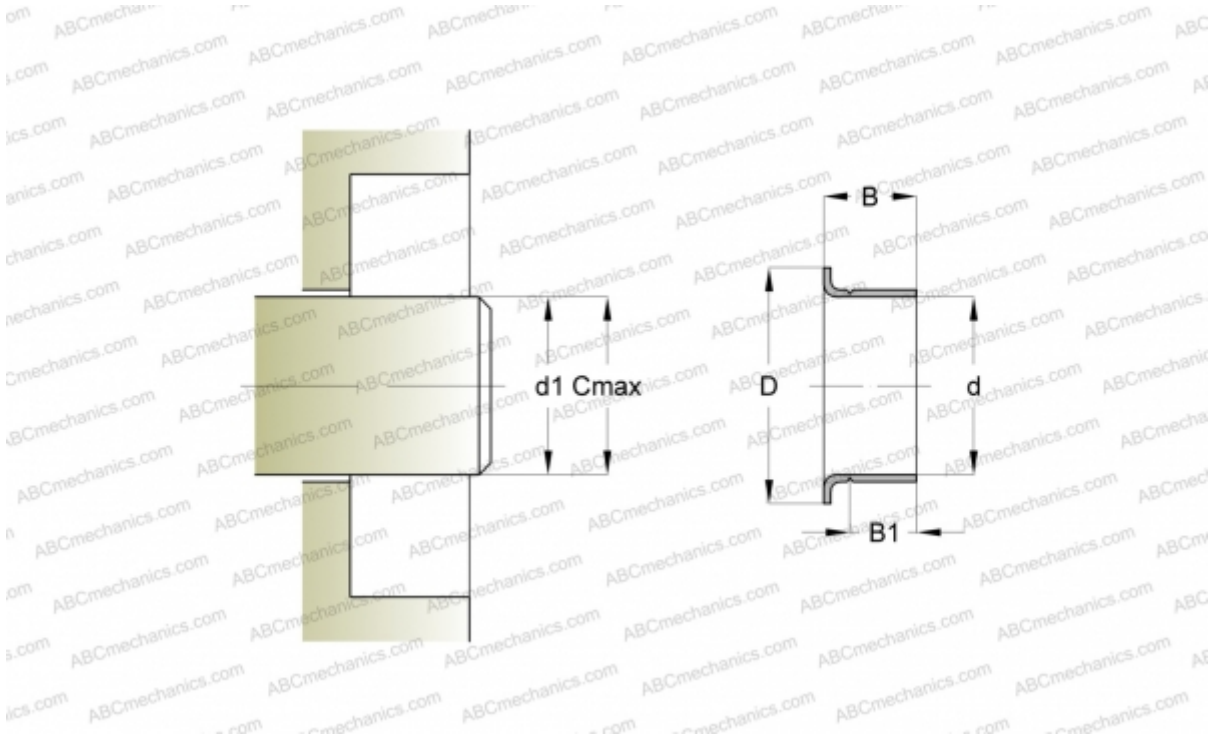

CR 99833 CR

Wear sleeves

TYPE: Wear sleeves, SKF Speedi-Sleeve, Speedi-Sleeve Gold, for heavy industrial applications (SKF)



Technical specification

DIMENSIONS, MM

d1	49,120
d	49,230
D	56,360
B	17,480
B1	14,300
C	49,280

MANUFACTURER [CR](#)

INTERCHANGE

SKF	99833
-----	-----------------------

CALCULATION DATA

Maximum shaft surface speed	0,001 m/s
-----------------------------	-----------

