

CR 99836 CR

Wear sleeves

TYPE: Wear sleeves, SKF Speedi-Sleeve, Speedi-Sleeve Gold, for heavy industrial applications (SKF)

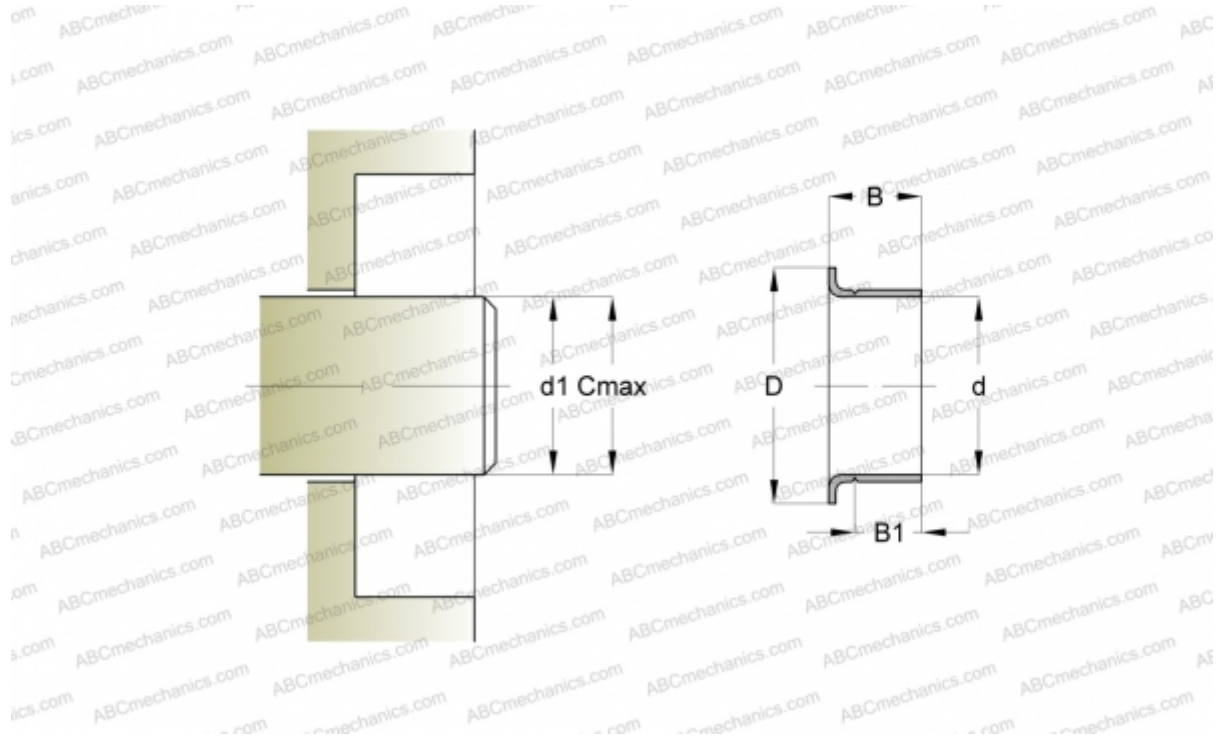

Technical specification

DIMENSIONS, MM

| | |
|----|--------|
| d1 | 53,950 |
| d | 53,980 |
| D | 61,520 |
| B | 23,830 |
| B1 | 19,840 |
| C | 54,100 |

MANUFACTURER [CR](#)

INTERCHANGE

SKF [99836](#)

CALCULATION DATA

Maximum shaft surface speed 0,001 m/s