

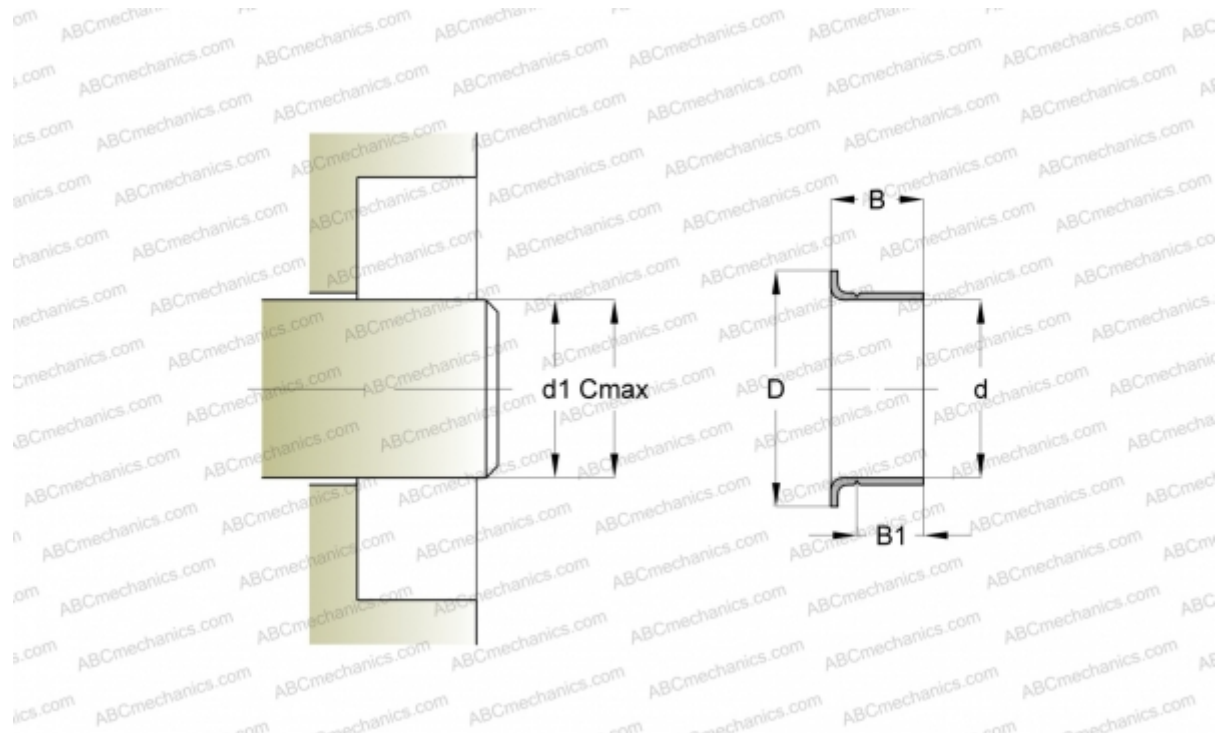

## CR 99863 CR

Wear sleeves

TYPE: Wear sleeves, SKF Speedi-Sleeve, Speedi-Sleeve Gold, for heavy industrial applications (SKF)



### Technical specification

#### DIMENSIONS, MM

d1	54,910
d	54,990
D	62,000
B	22,990
B1	19,990
C	55,070

#### MANUFACTURER

[CR](#)

#### INTERCHANGE

SKF	<a href="#">99863</a>
-----	-----------------------

#### CALCULATION DATA

Maximum shaft surface speed	0,001 m/s
-----------------------------	-----------

