

## 99869 SKF

Wear sleeves

TYPE: Wear sleeves, SKF Speedi-Sleeve, Speedi-Sleeve Gold, for heavy industrial applications (SKF)

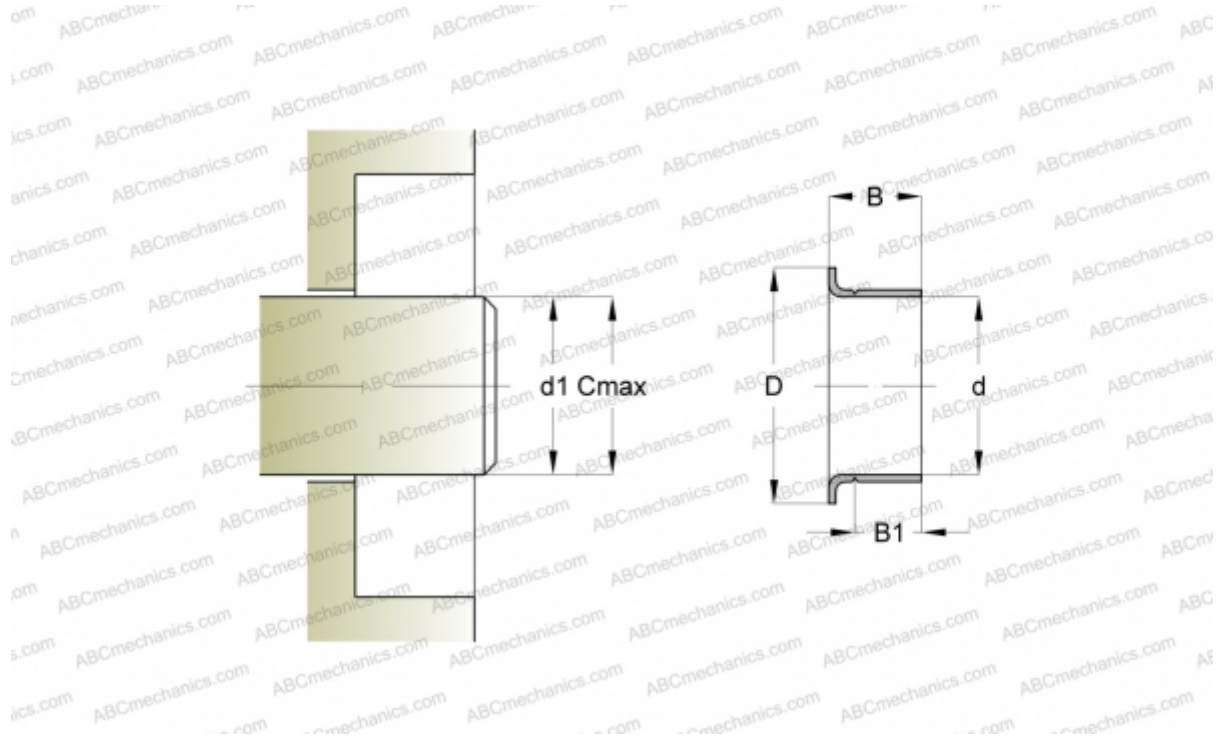

### Technical specification

#### DIMENSIONS, MM

|    |        |
|----|--------|
| d1 | 59,920 |
| d  | 59,990 |
| D  | 70,740 |
| B  | 22,990 |
| B1 | 19,990 |
| C  | 60,070 |

**MANUFACTURER** [SKF](#)

#### INTERCHANGE

CR [CR 99869](#)

#### CALCULATION DATA

Maximum shaft surface speed 0,001 m/s