

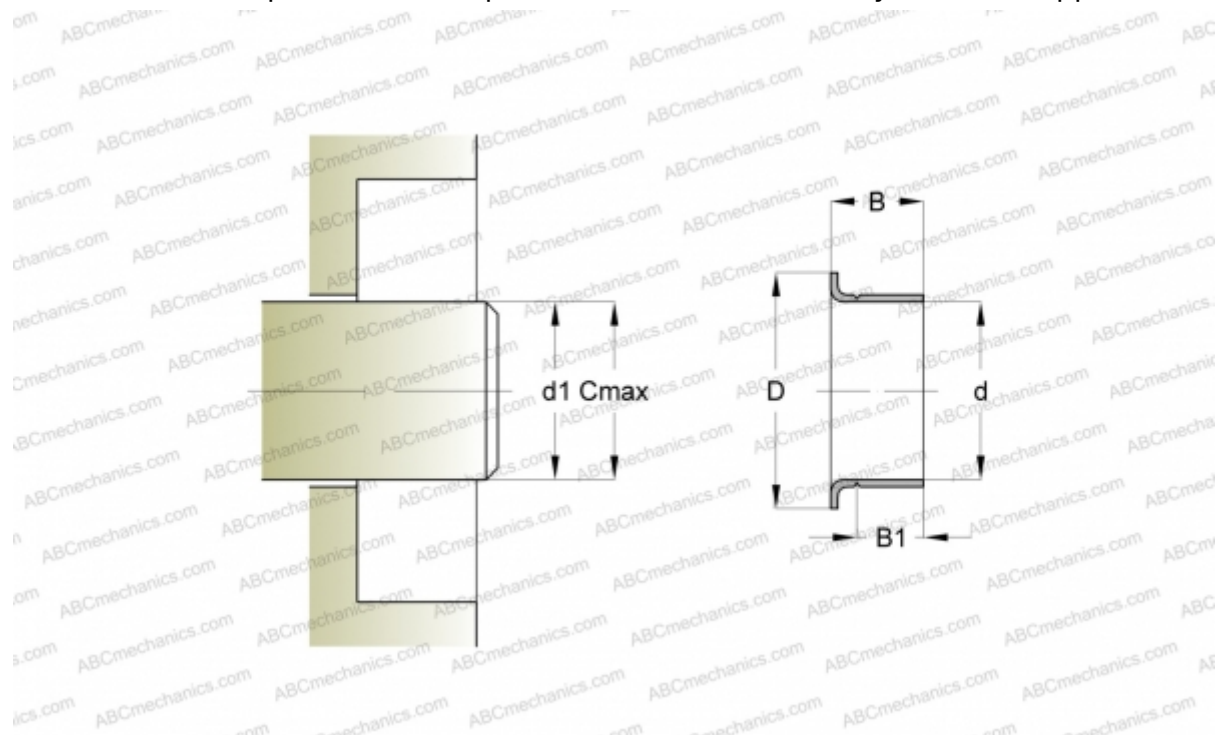

99839 SKF

Wear sleeves

TYPE: Wear sleeves, SKF Speedi-Sleeve, Speedi-Sleeve Gold, for heavy industrial applications (SKF)



Technical specification

DIMENSIONS, MM

d1	60,300
d	60,330
D	69,850
B	23,830
B1	19,840
C	60,450

MANUFACTURER

[SKF](#)

INTERCHANGE

CR	CR 99839
----	--------------------------

CALCULATION DATA

Maximum shaft surface speed	0,001 m/s
-----------------------------	-----------

