

## CR 99839 CR

Wear sleeves

TYPE: Wear sleeves, SKF Speedi-Sleeve, Speedi-Sleeve Gold, for heavy industrial applications (SKF)

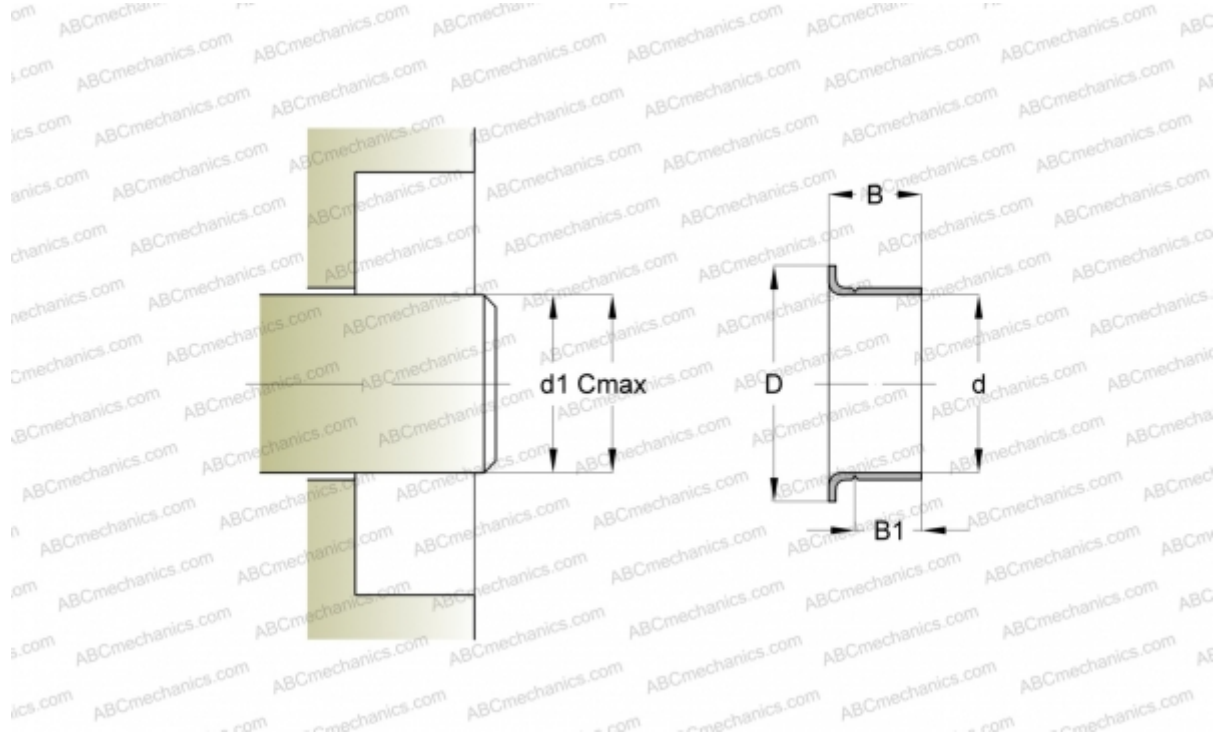

### Technical specification

#### DIMENSIONS, MM

d1	60,300
d	60,330
D	69,850
B	23,830
B1	19,840
C	60,450

**MANUFACTURER** [CR](#)

#### INTERCHANGE

SKF [99839](#)

#### CALCULATION DATA

Maximum shaft surface speed 0,001 m/s