

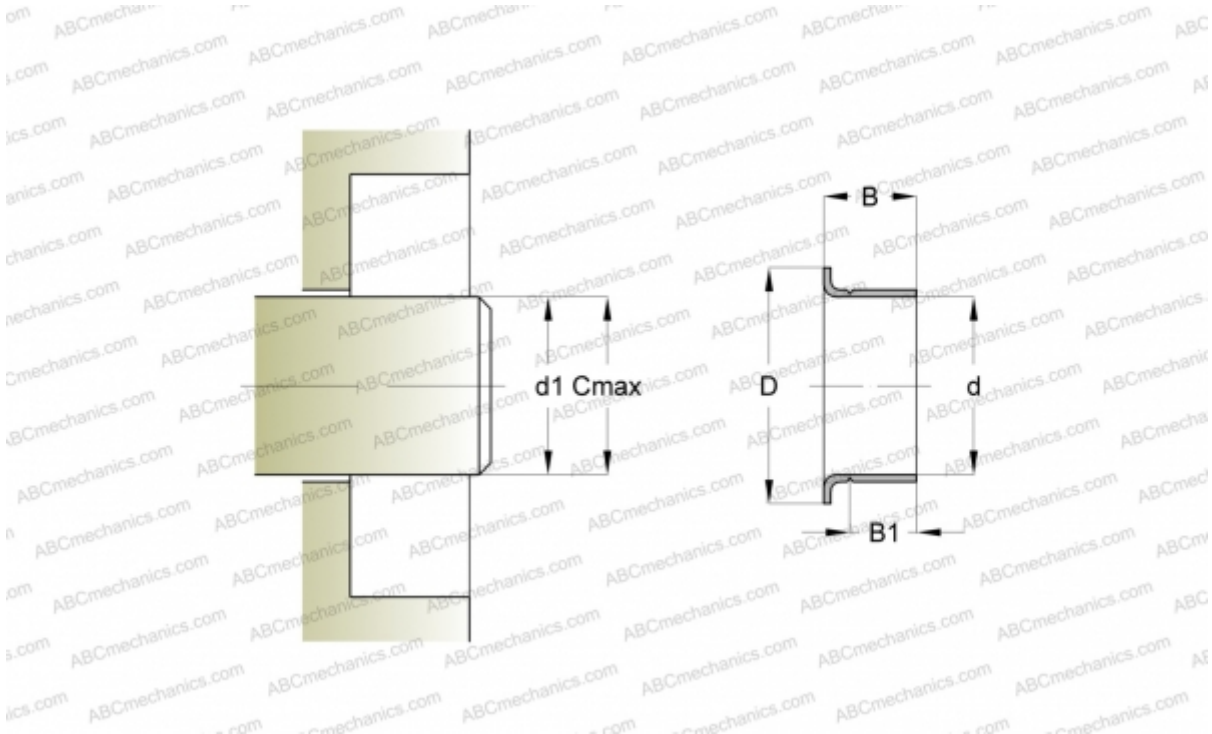

CR 99840 CR

Wear sleeves

TYPE: Wear sleeves, SKF Speedi-Sleeve, Speedi-Sleeve Gold, for heavy industrial applications (SKF)



Technical specification

DIMENSIONS, MM

d1	63,500
d	63,500
D	71,630
B	23,830
B1	19,840
C	63,650

MANUFACTURER [CR](#)

INTERCHANGE

SKF	99840
-----	-----------------------

CALCULATION DATA

Maximum shaft surface speed	0,001 m/s
-----------------------------	-----------

